

XXXXXXXXXXXX serie: xxx

 Hergestellt für:

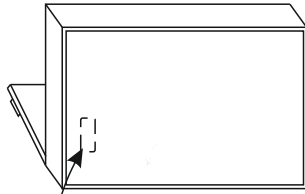

<http://www.bega-gruppe.de>

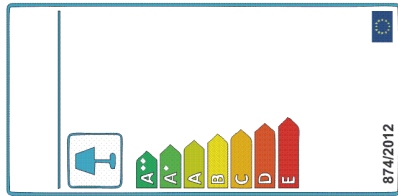

- | | | |
|----|----------------|-------------|
| BG | Bulgarisch | Български |
| CS | Tschechisch | čeština |
| DA | Dänisch | Dansk |
| DE | Deutsch | Deutsch |
| ET | Eströisch | Eesti |
| EL | Griechisch | ελληνικά |
| EN | English | English |
| ES | Spanisch | español |
| FR | Französisch | Français |
| FI | Finnisch | suomalainen |
| HR | Kroatisch | hrvatski |
| HU | Ungarisch | magyar |
| IT | Italienisch | italiano |
| LV | Lettisch | latvijas |
| LT | Litauisch | Lietuvos |
| NL | Niederländisch | Nederlands |
| PL | Polnisch | Polski |
| PT | Portugiesisch | português |
| RO | Rumänisch | român |
| SK | Slowakisch | slovenský |
| SL | Slowenisch | slovensčina |
| SV | Schwedisch | Svenska |

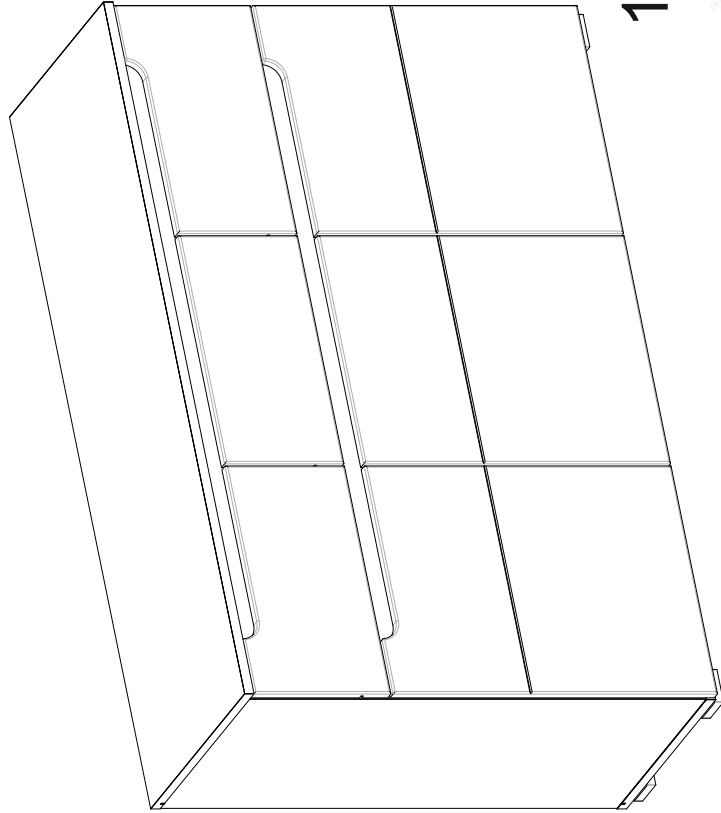

120 min

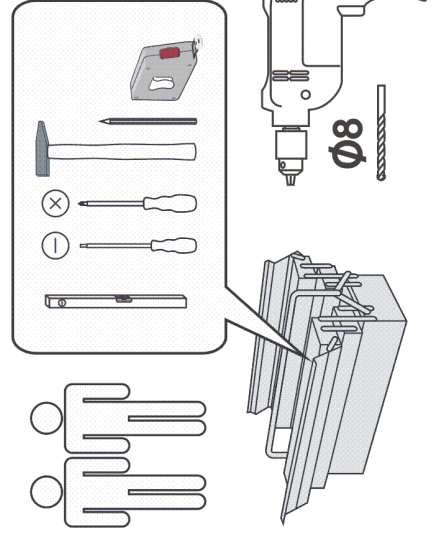
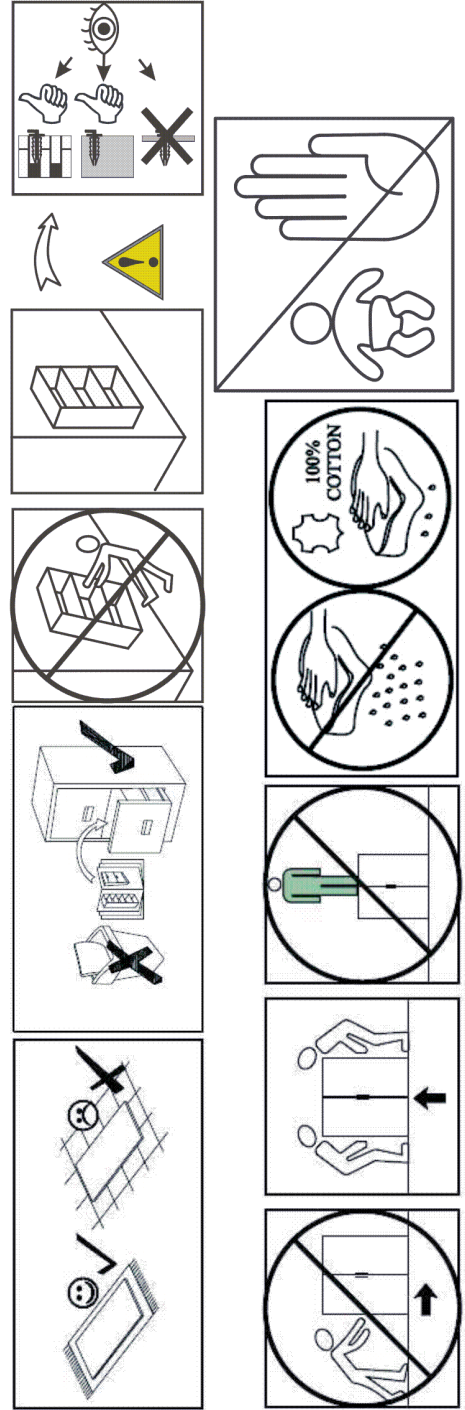



- | | | | | |
|--------------------------|---------------------------|------------------------|-------------------------|-------------------------|
| 39
3x20
x40 | 11
3.5x13
x6 | 9
ø15
x8 | 26
x1 | 4A
4x16
x9 |
| 92A
L350
x3 | 92B
L350
x3 | 24
ø12
x6 | 6
5x11
x32 | 38
x17 |
| 5
ø26
x4 | 29P
ø26
x2 | 13
x12 | 35
x14 | 10
x6 |
| 22A
x14 | 41
x1 | 80
x1 | 31C
x4 | 9A
x8 |
| 1
x36 | 22
x14 | 2
x14 | | |

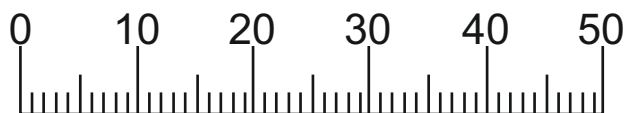

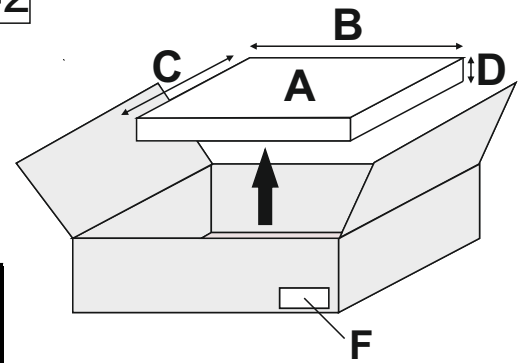
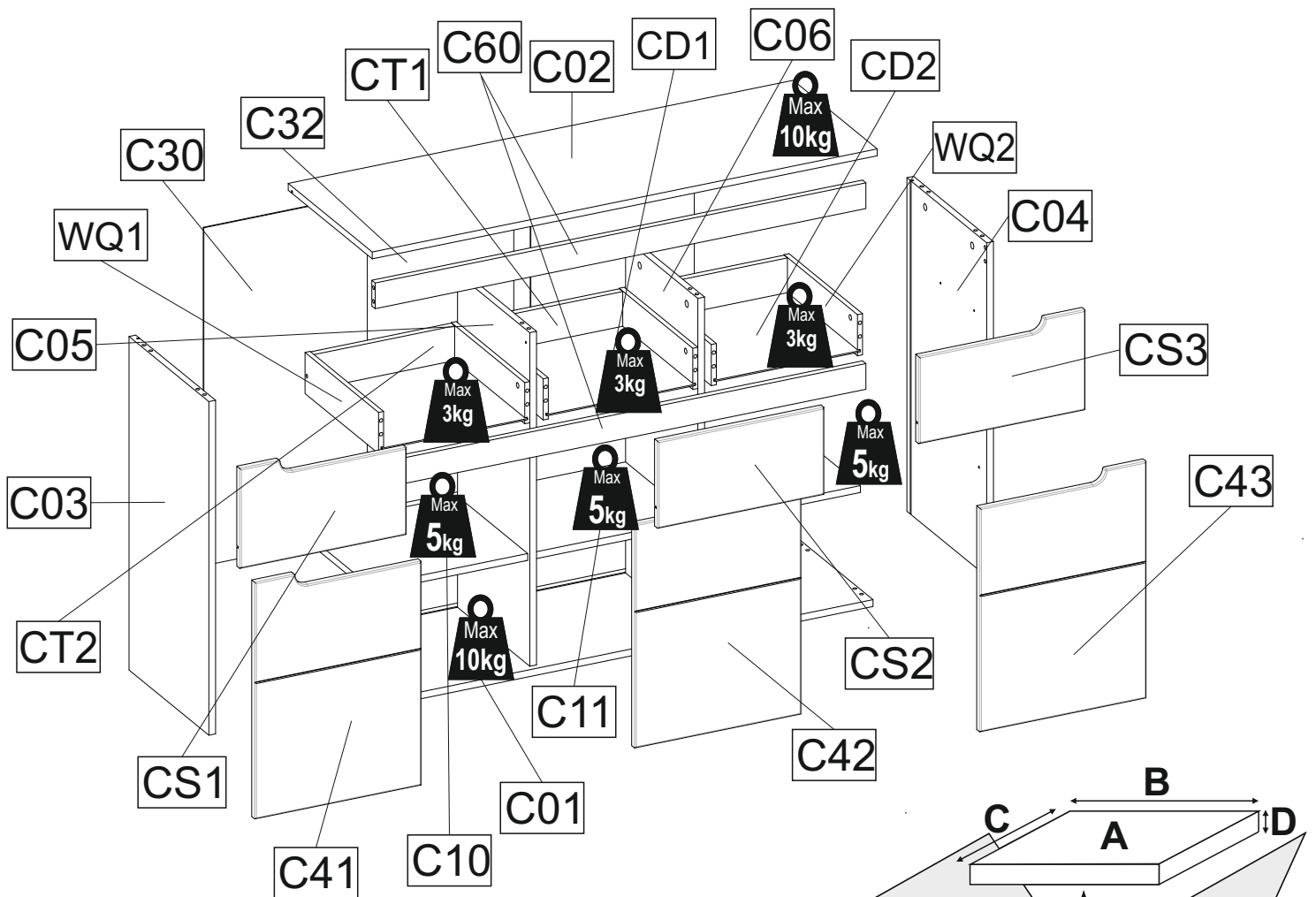

A	B (mm)	C (mm)	D (mm)	E	F
C01	1202	380	16	1	2 2
C02	1202	400	16	1	2 2
C03	778	380	16	1	1 2
C04	778	380	16	1	1 2
C05	778	344	16	1	1 2
C06	778	344	16	1	1 2
C10	376	334	16	2	2 2
C11	384	334	16	1	2 2
C30	788	389	3	2	2 2
C32	788	400	3	1	2 2
C41	552	396	16	1	1 2
C42	522	396	16	1	1 2
C43	552	396	16	1	1 2
C60	1168	60	16	2	2 2
CD1	354	353	3	1	2 2
CD2	346	353	3	2	2 2
CS1	396	233	16	1	1 2
CS2	396	203	16	1	1 2
CS3	396	233	16	1	1 2
CT1	344	81	16	1	2 2
CT2	336	81	16	2	2 2
WQ1	350	96	12	3	2 2
WQ2	350	96	12	3	2 2

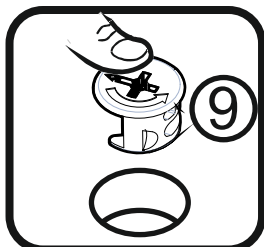
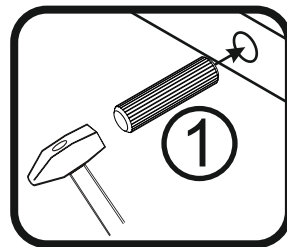
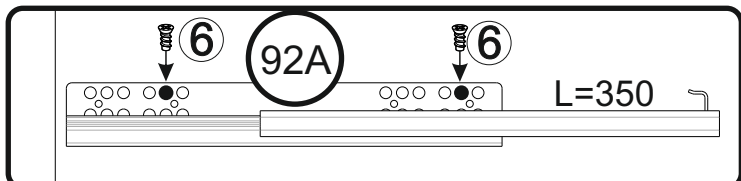
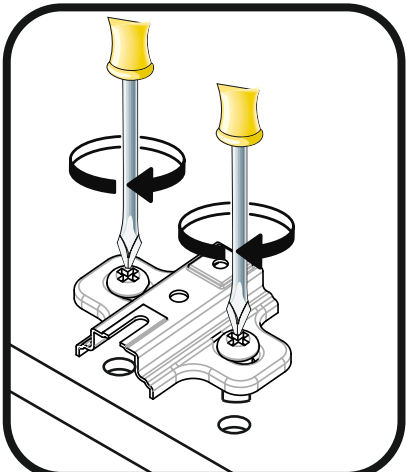
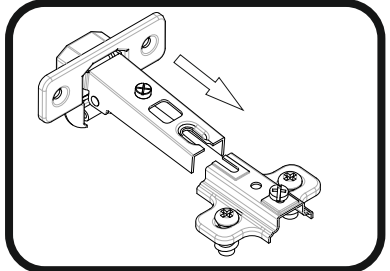
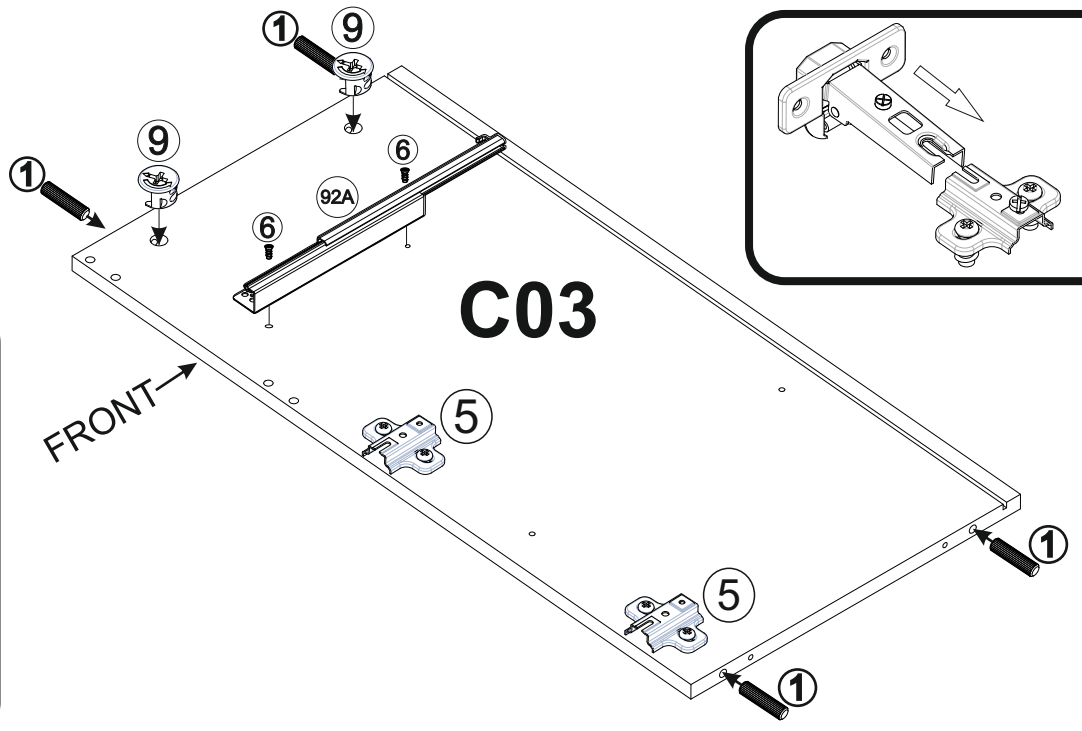
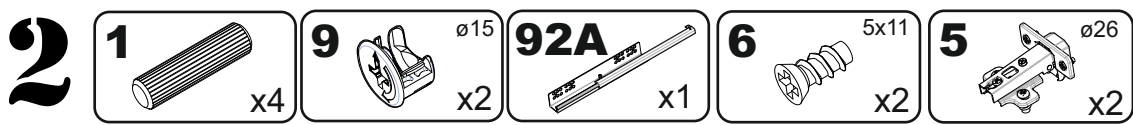
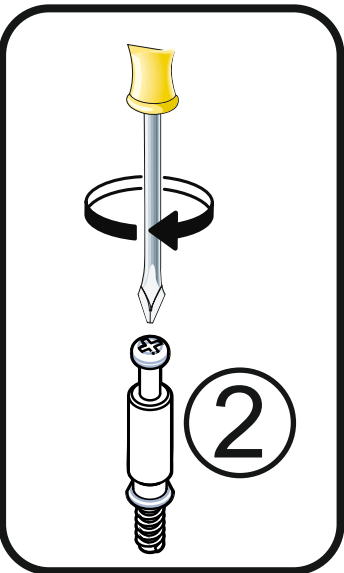
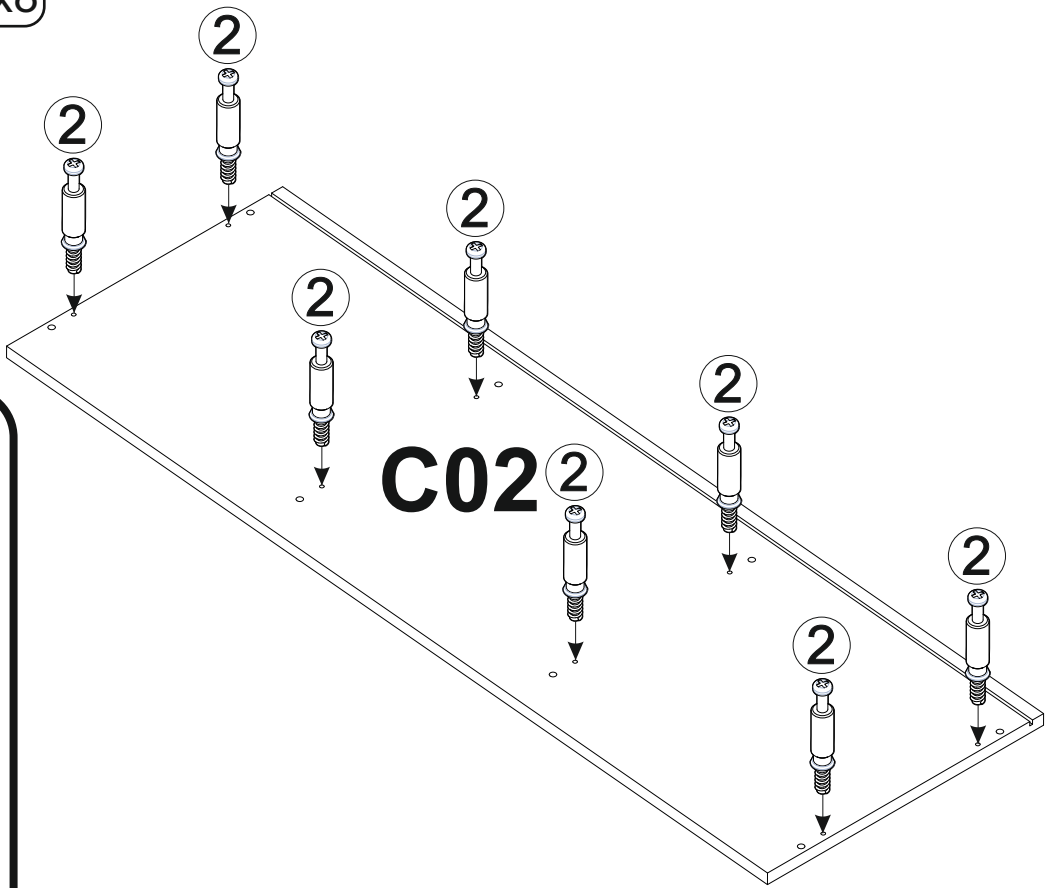
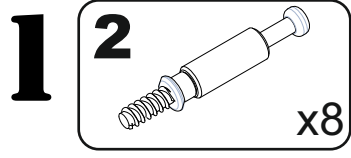

- 3** **1** x4 **9** $\varnothing 15$ x2 **92B** x1 **6** 5x11 x2 **5** $\varnothing 26$ x2

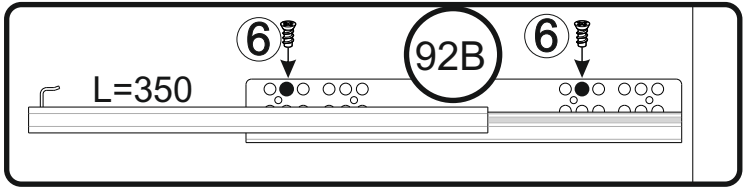
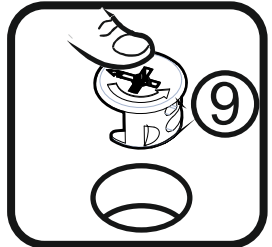
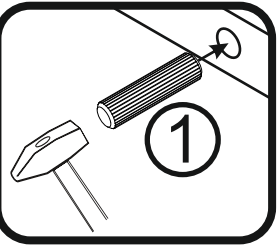
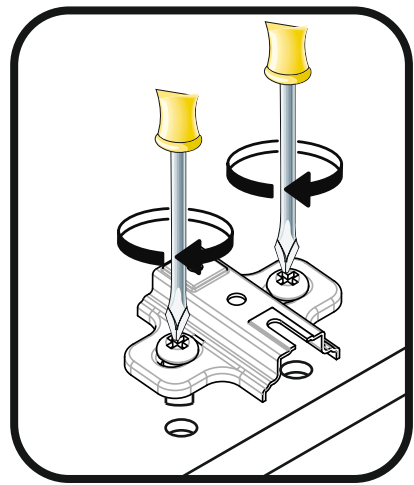
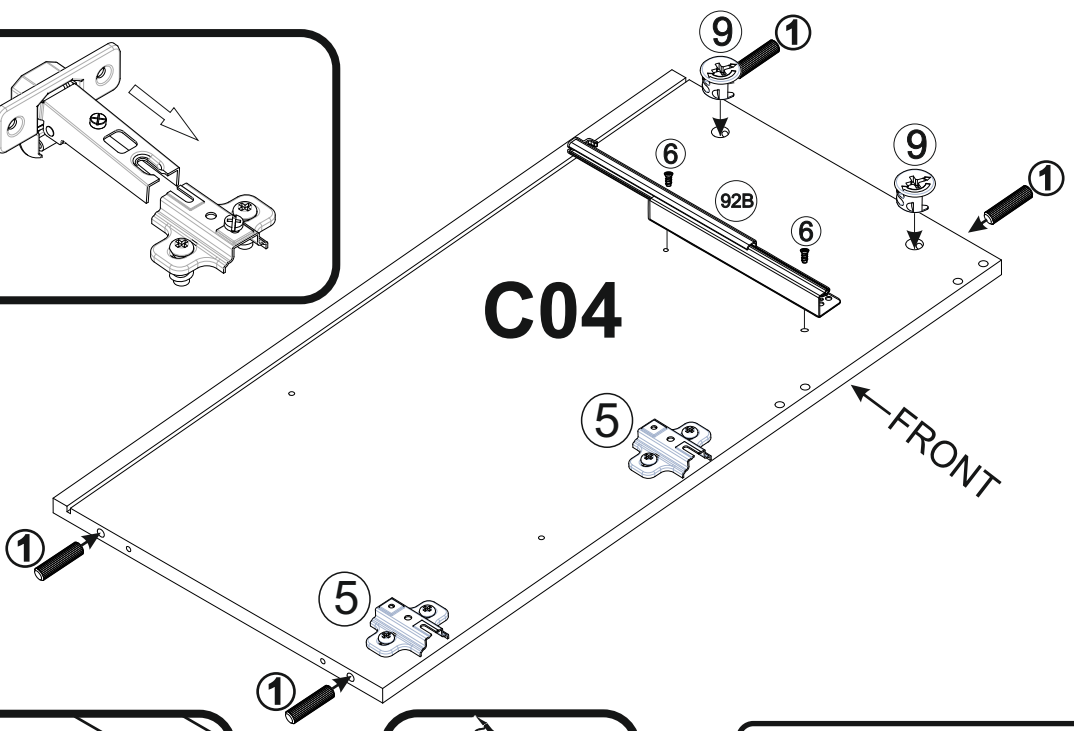
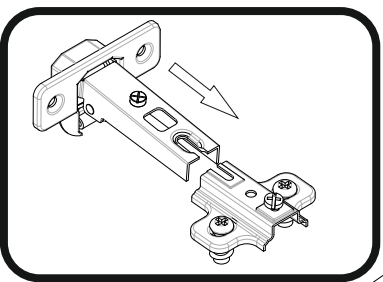

- 4** **1** x4 **9** $\varnothing 15$ x2 **92A** x1 **6** 5x11 x2

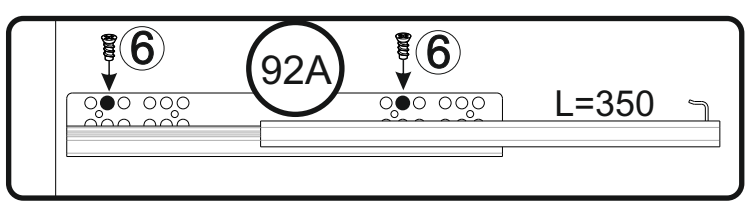
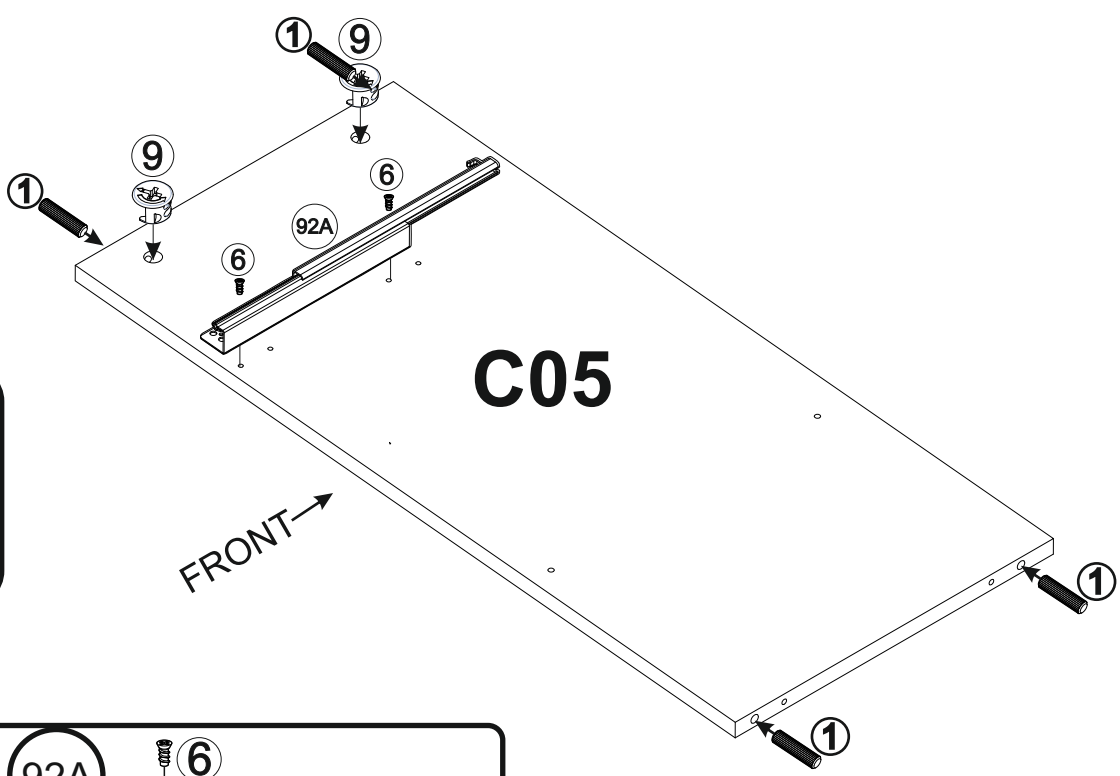
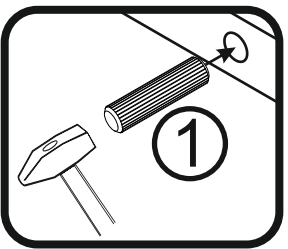
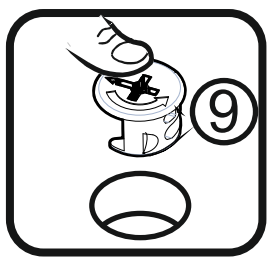

5

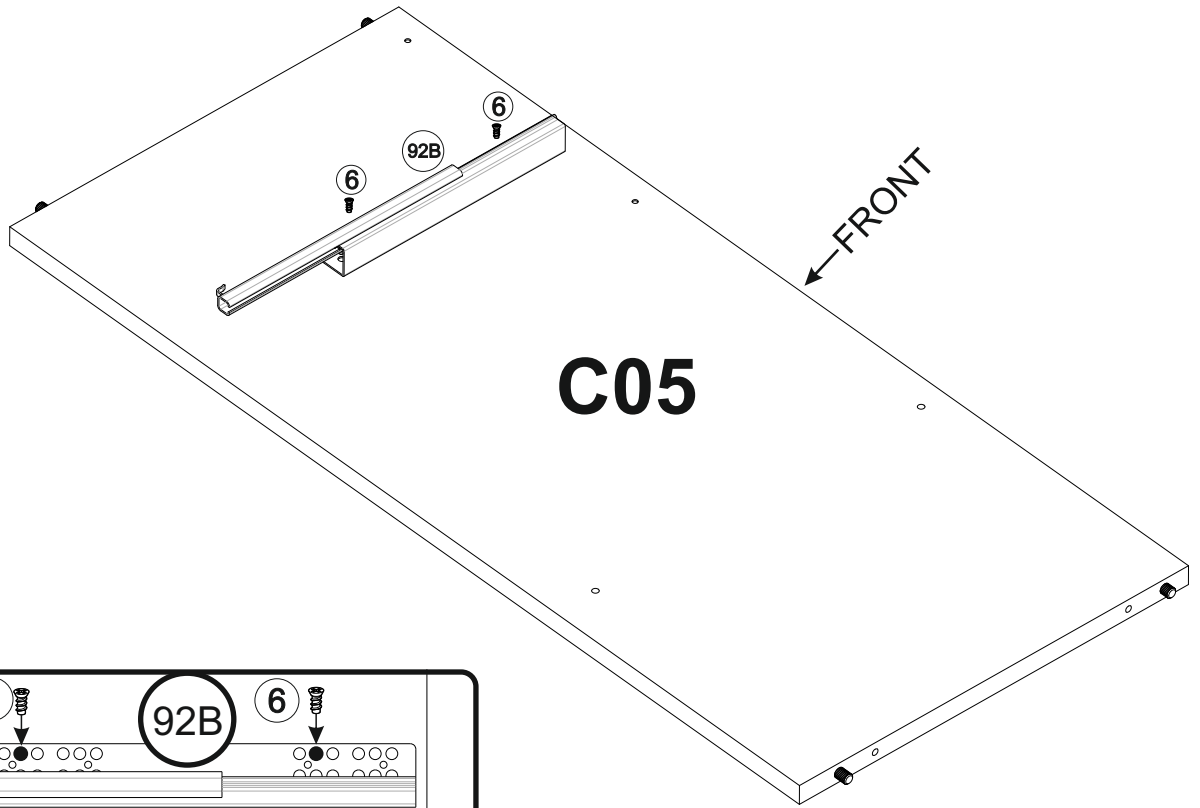
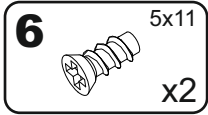
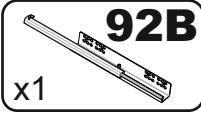

6

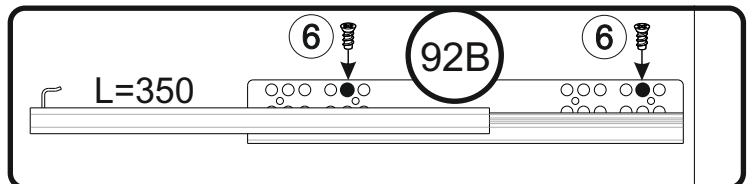
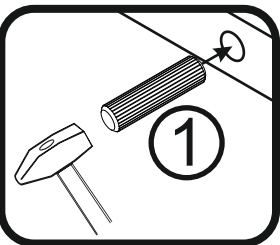
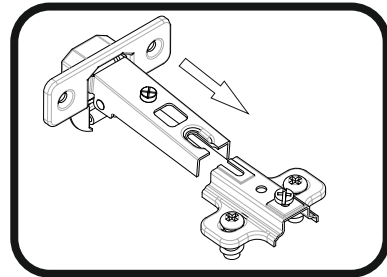
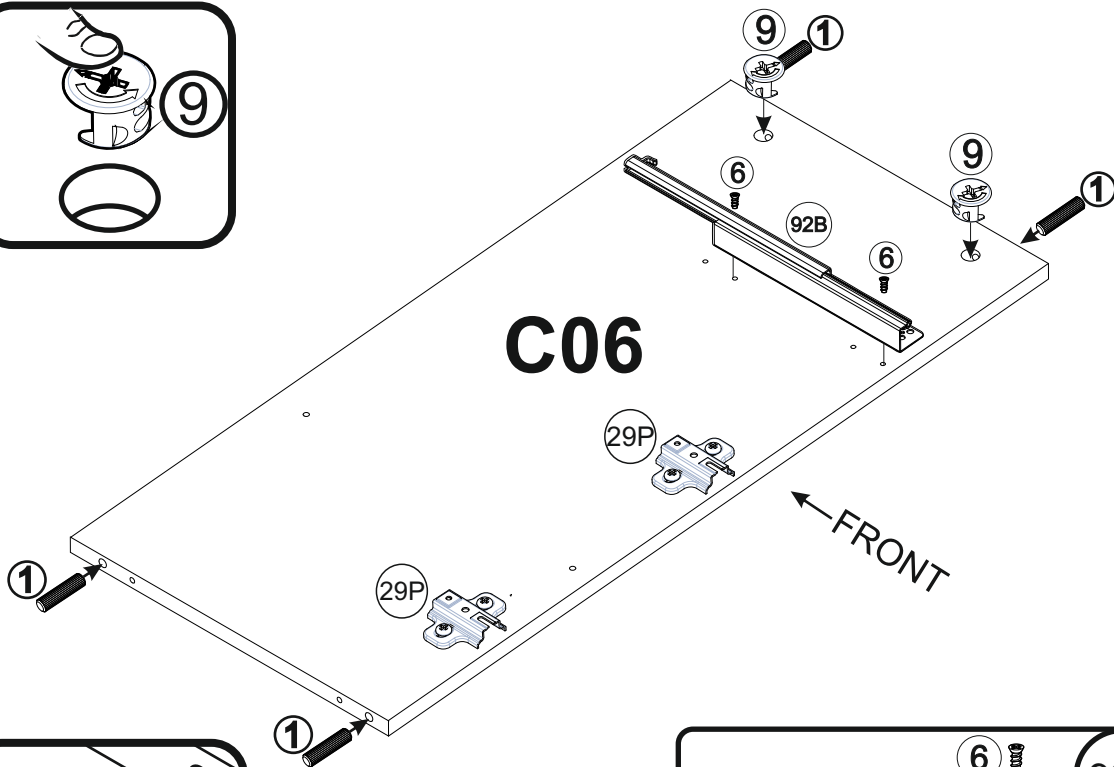
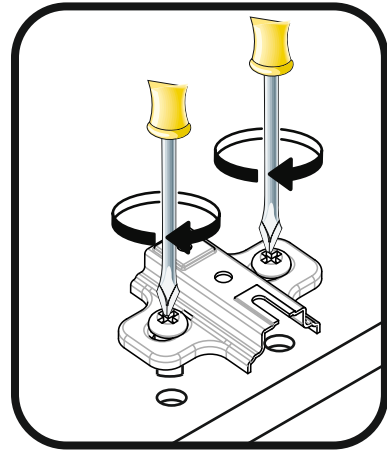
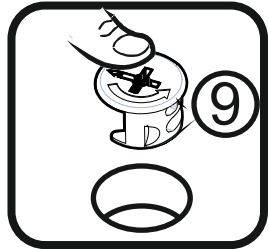
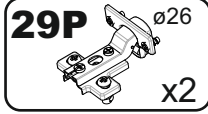
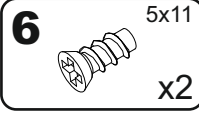
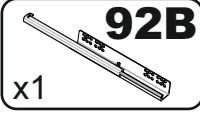
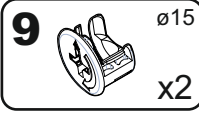
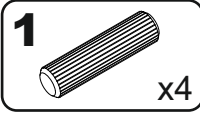

7

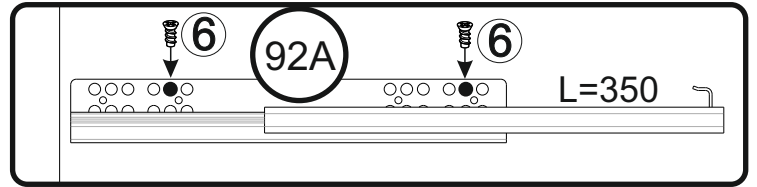
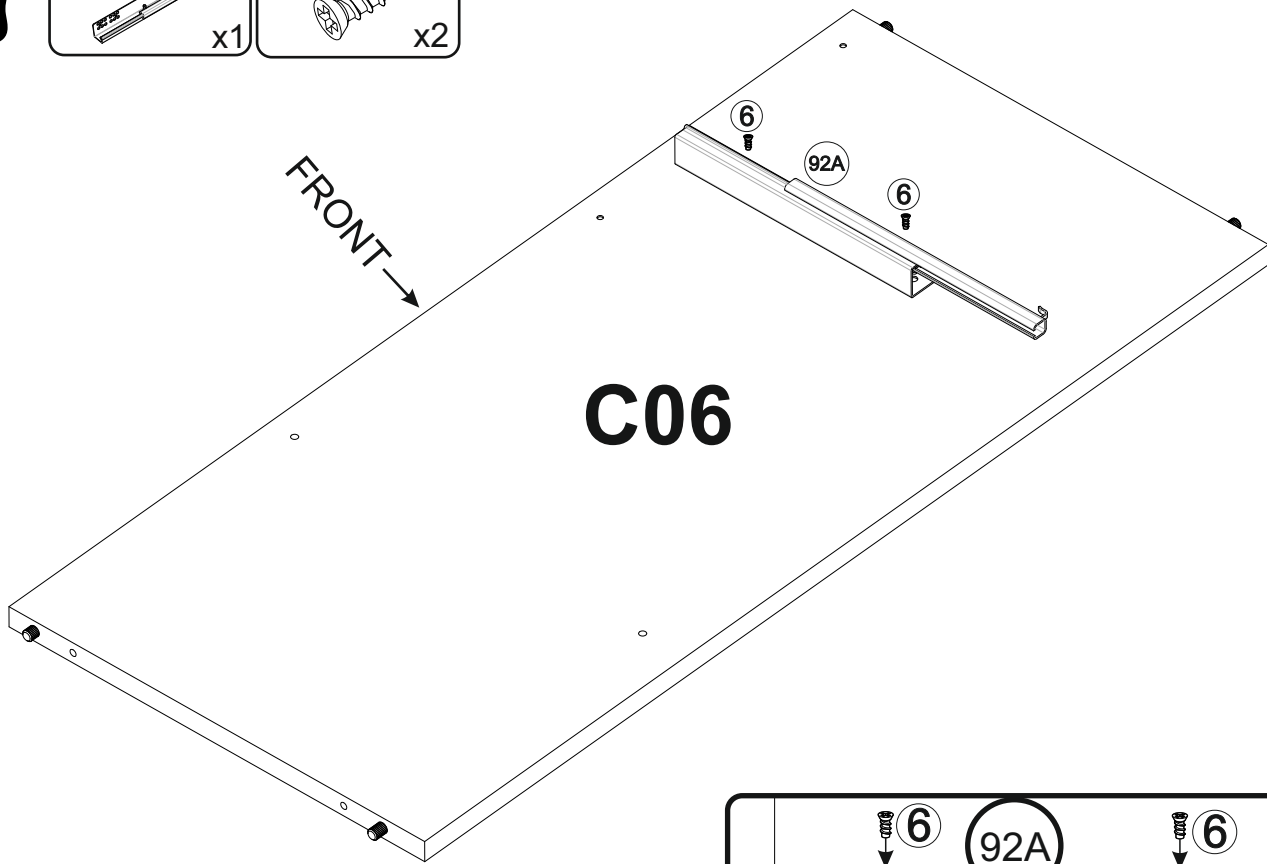
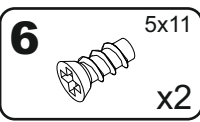
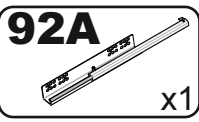

8

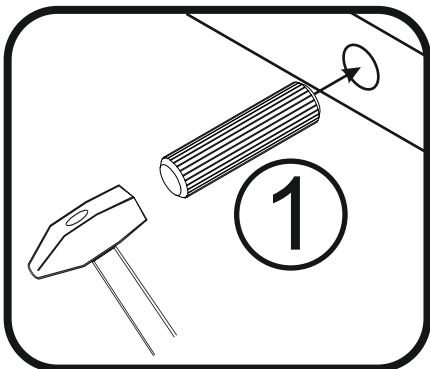
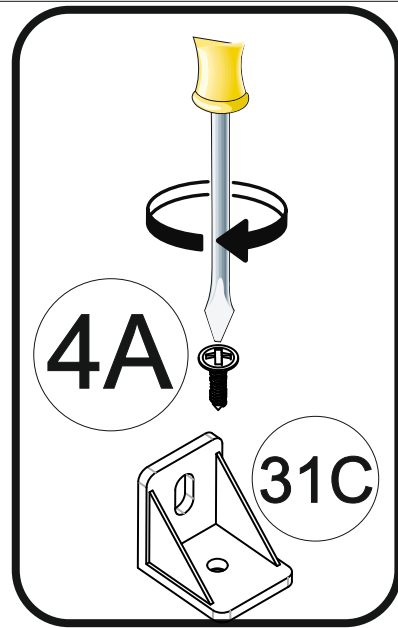
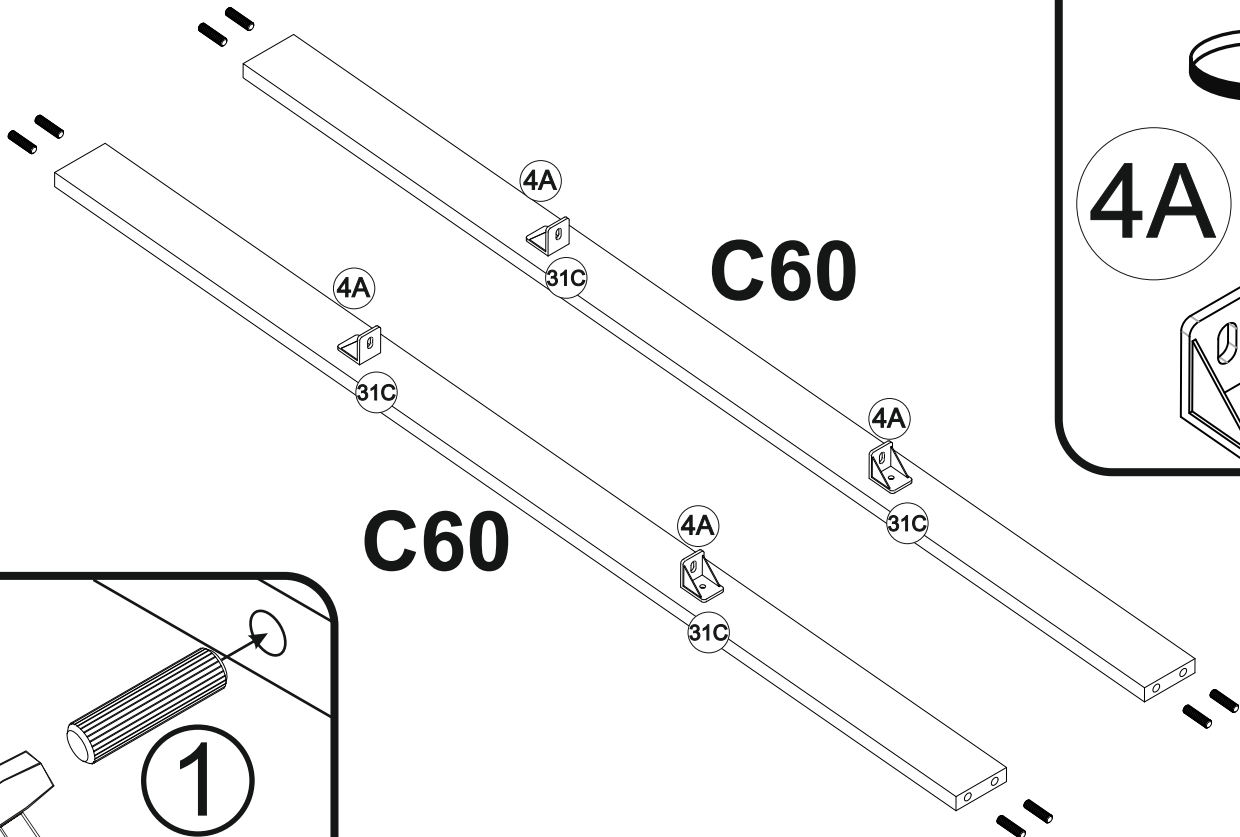
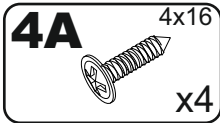
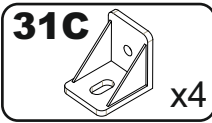
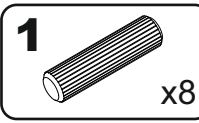

9

5

ø26

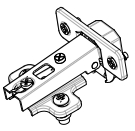

x2

6

5x11

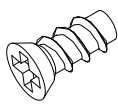

x4

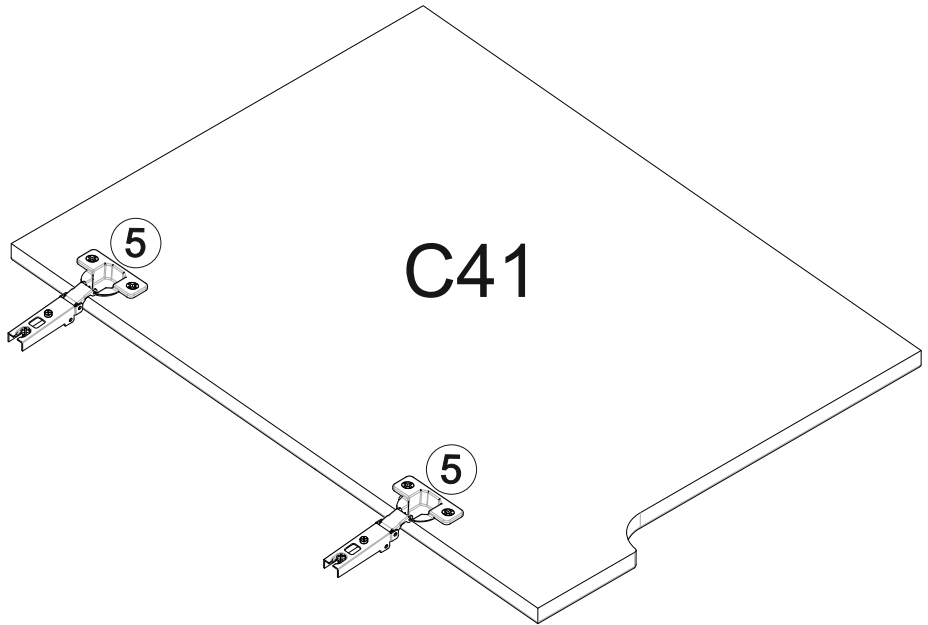
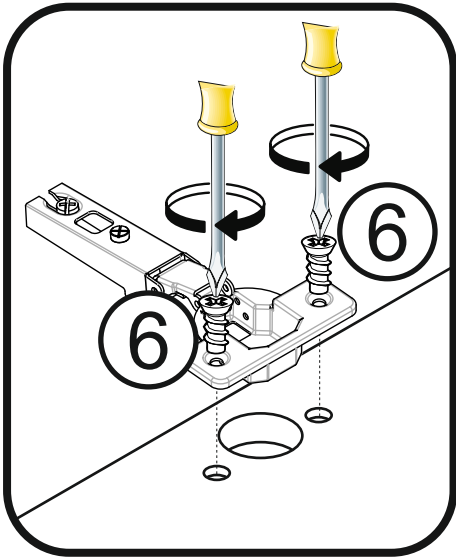

10

29P

ø26

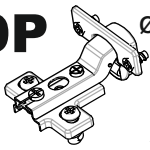

x2

6

5x11

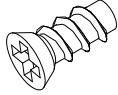

x4

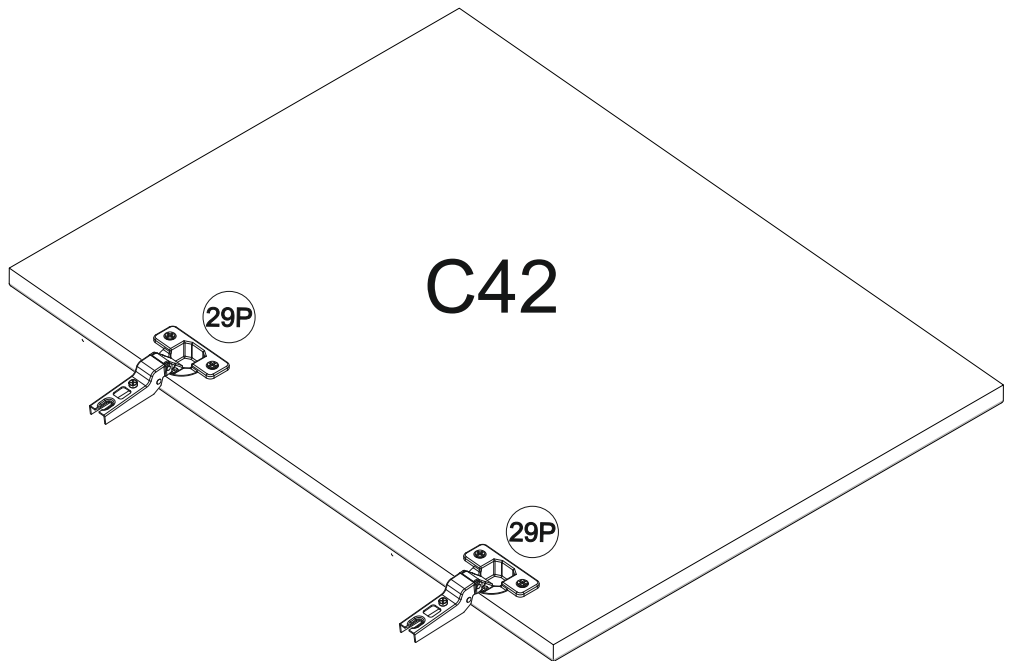
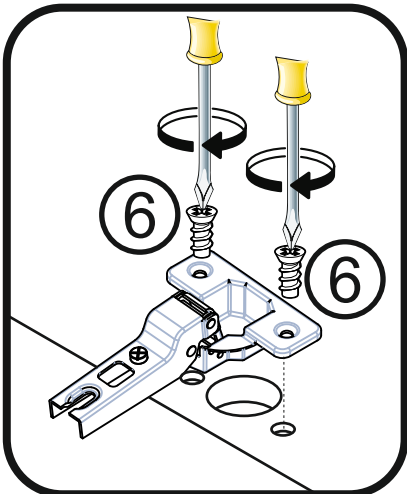

11

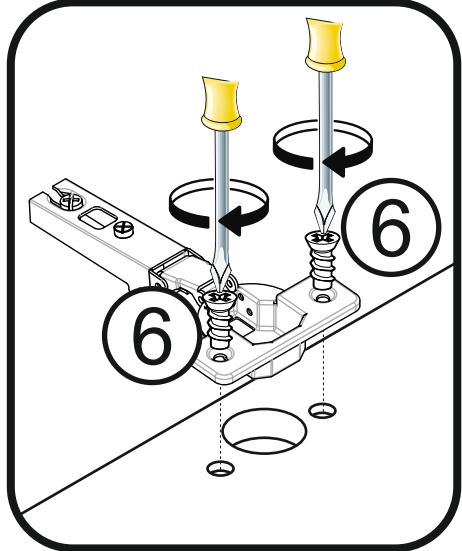
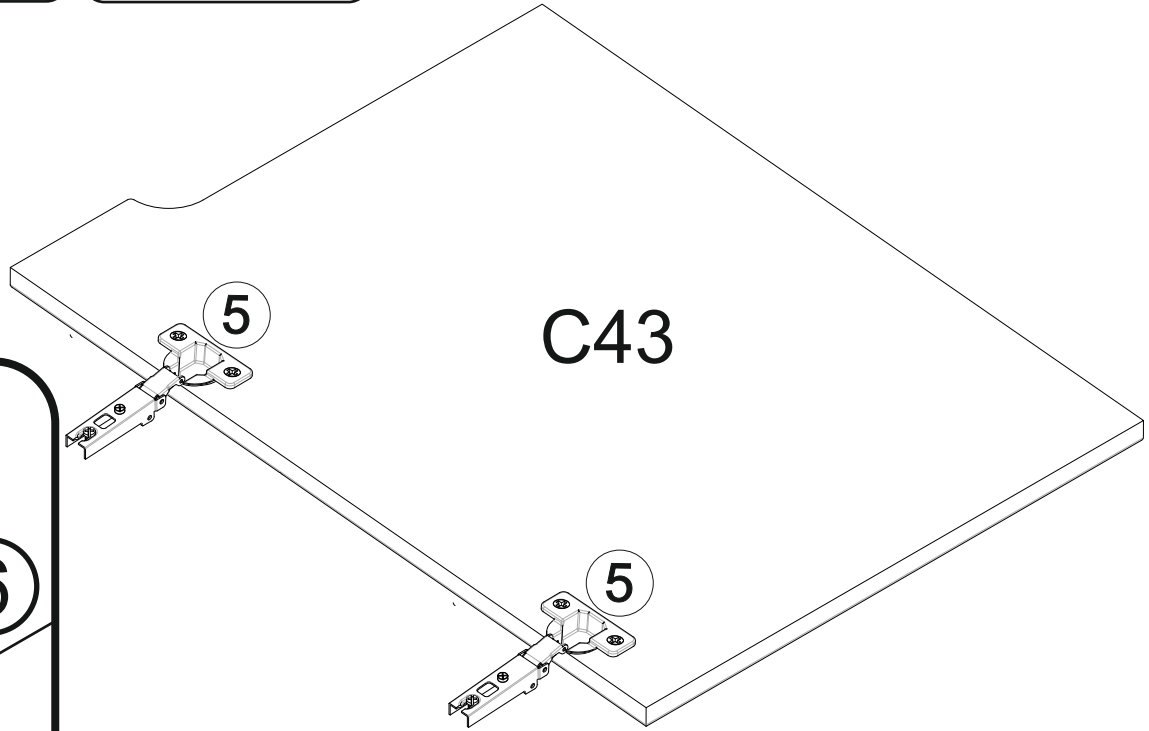
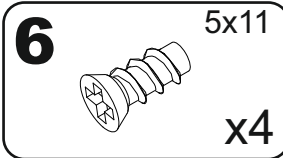
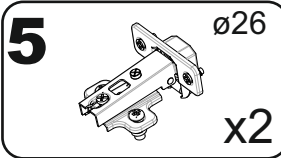

12

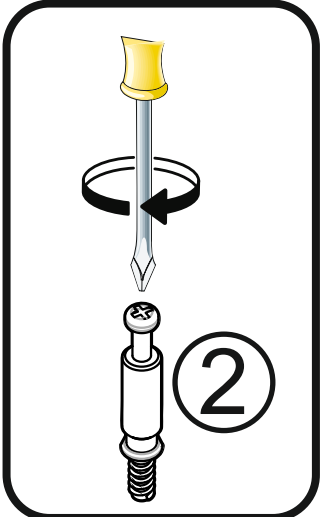
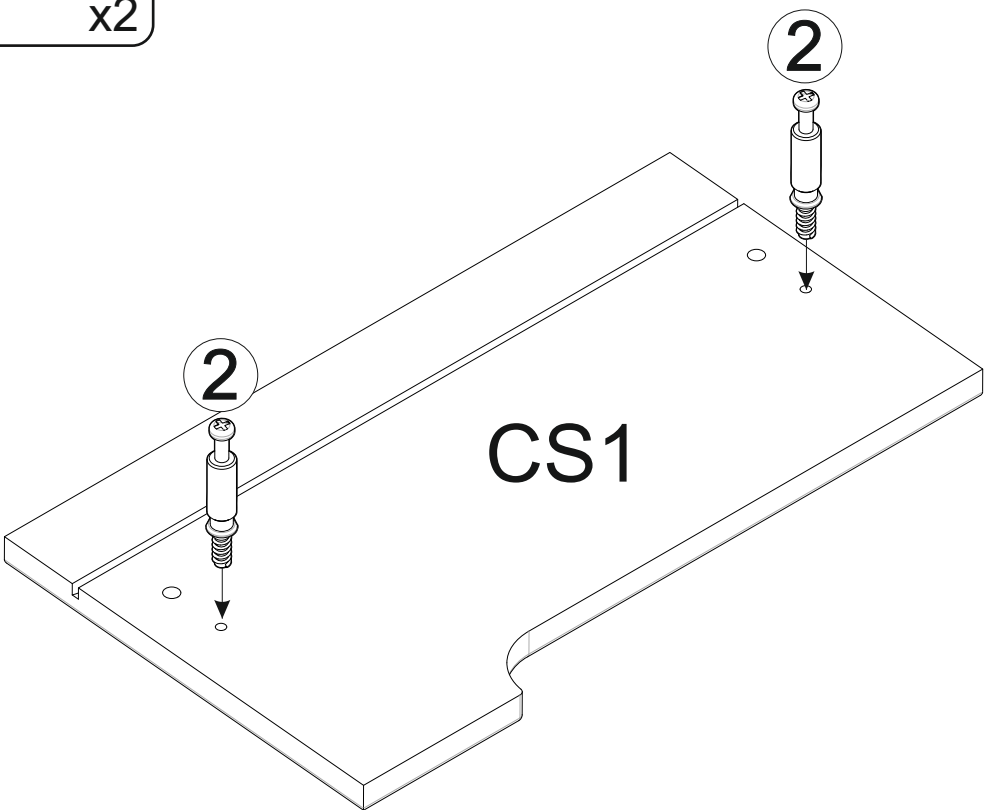
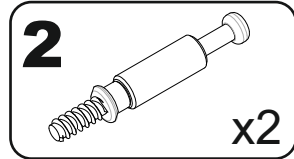

13

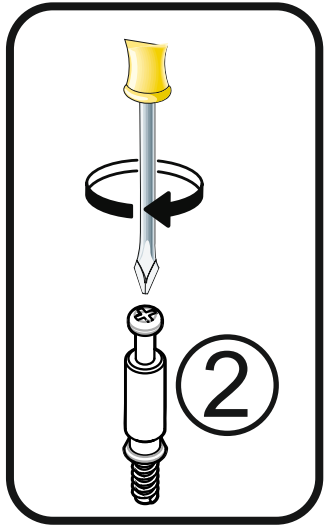
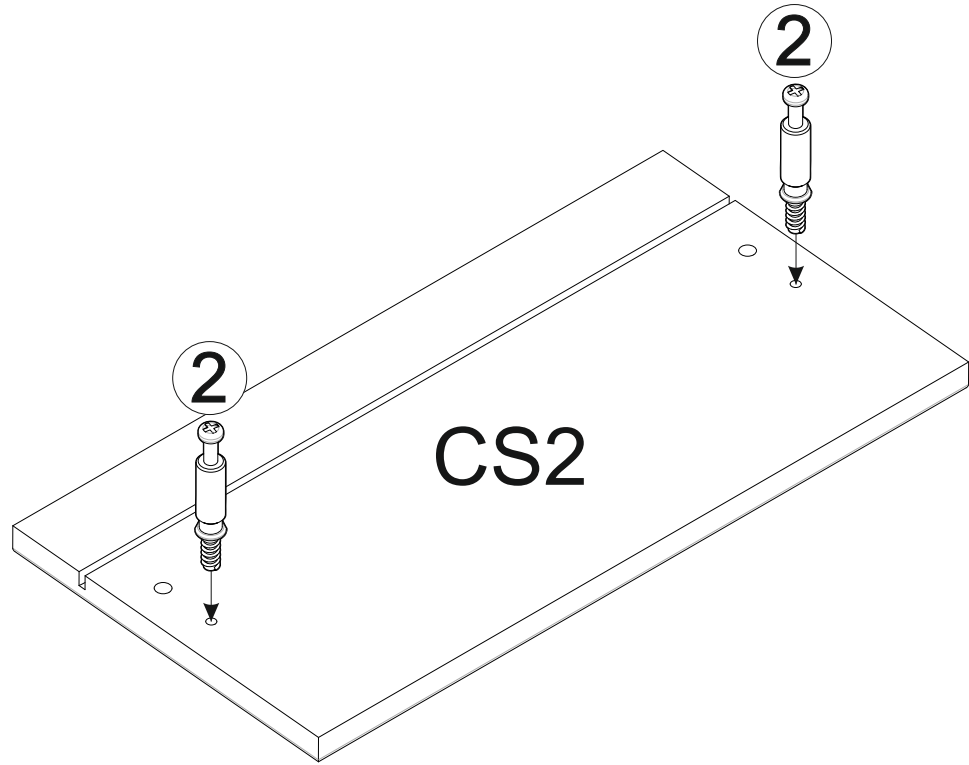
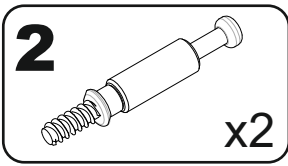

14

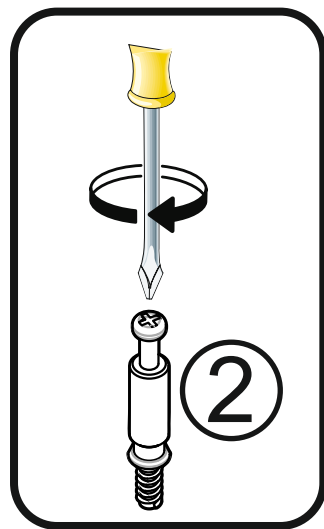
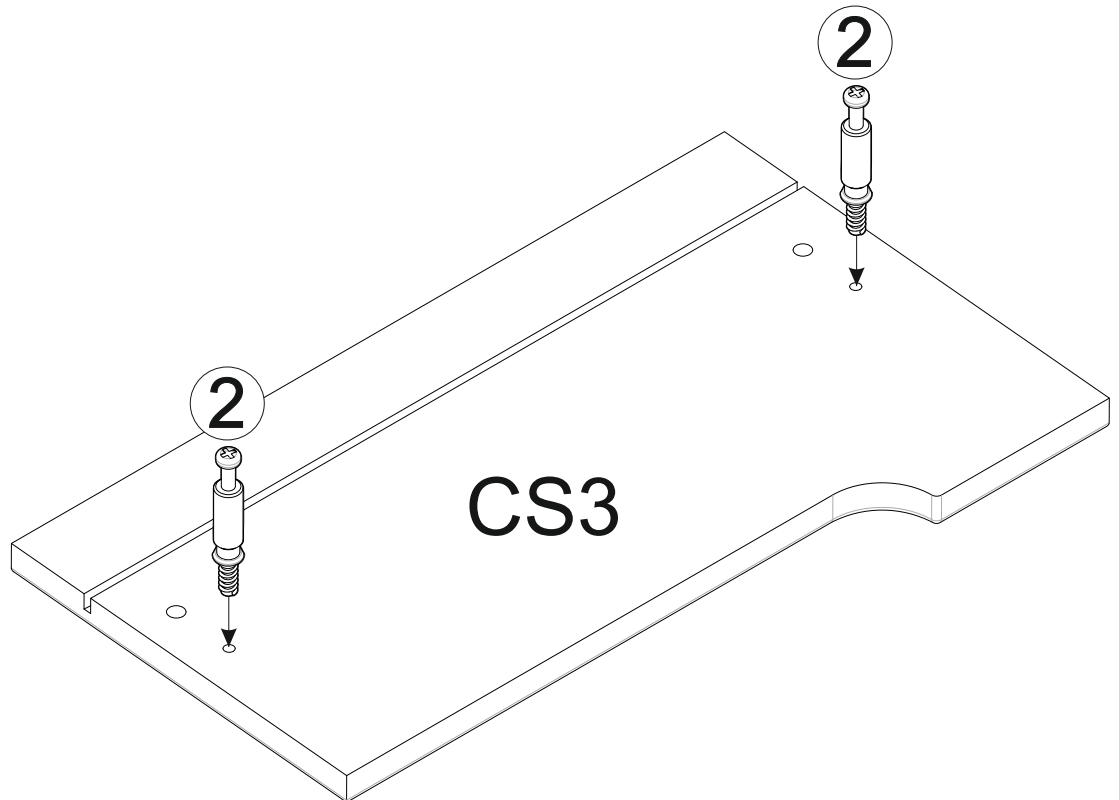
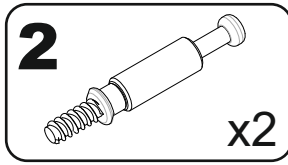

15

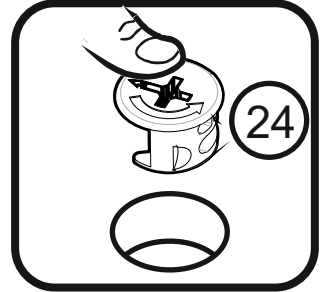
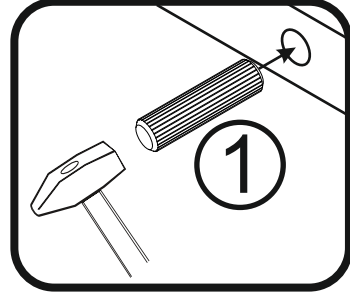
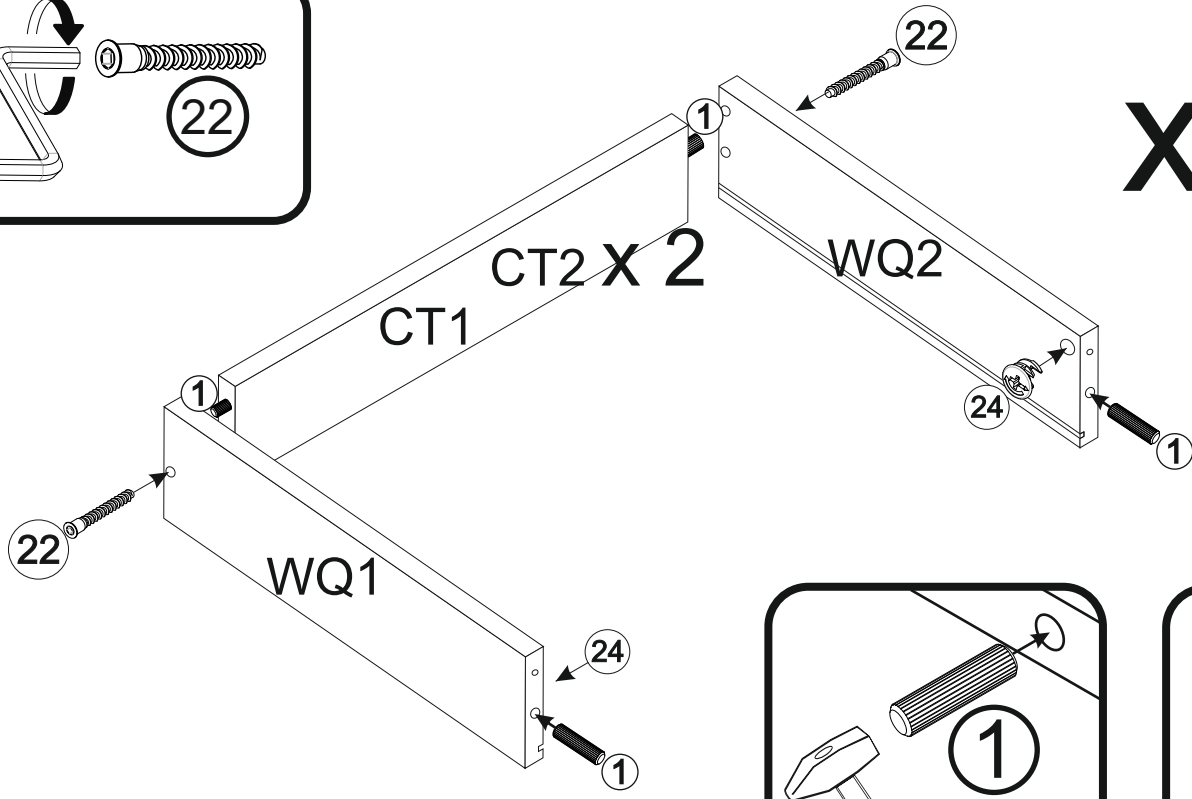
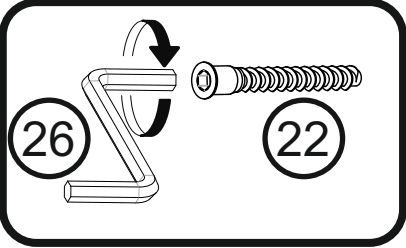
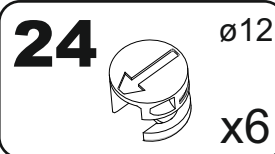
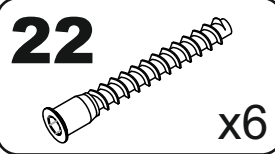
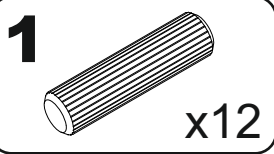

16

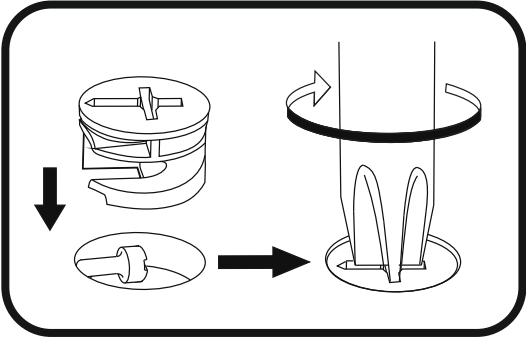
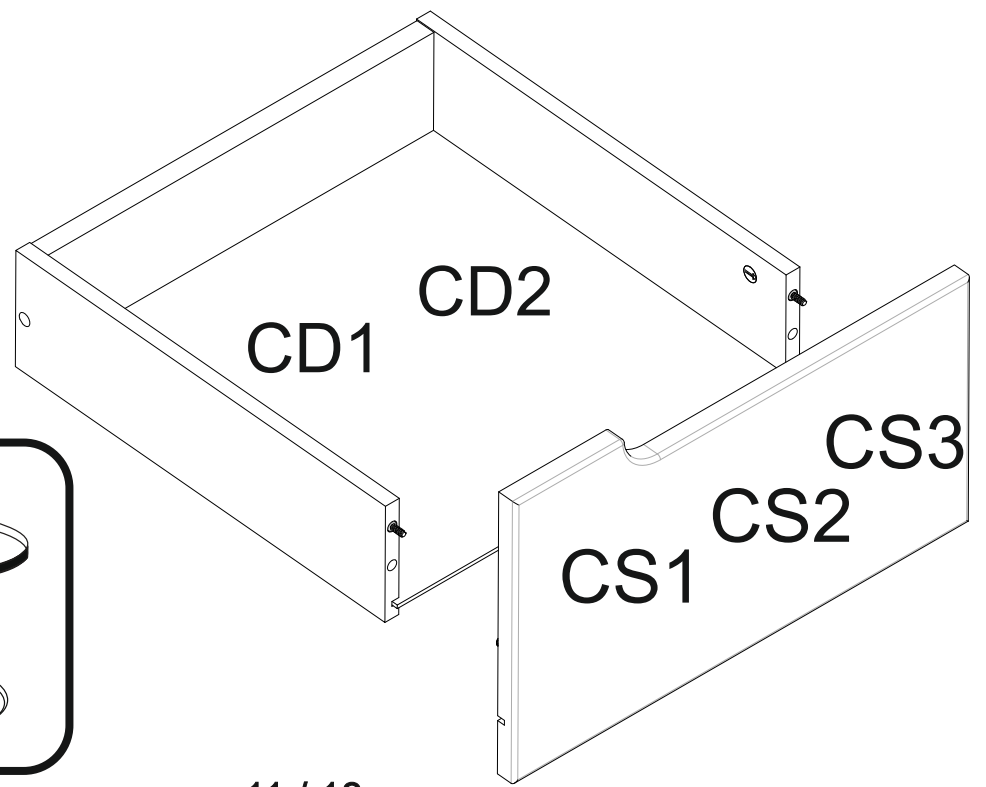
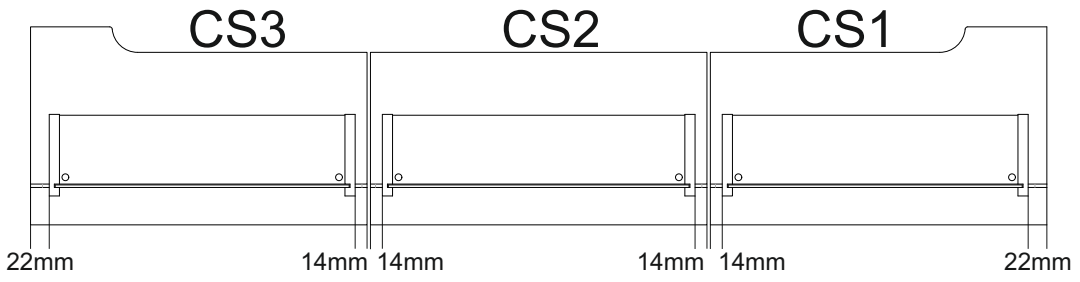

17

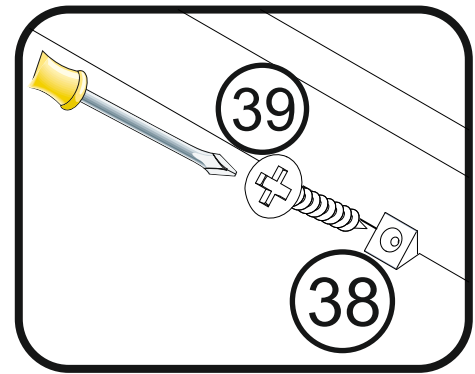
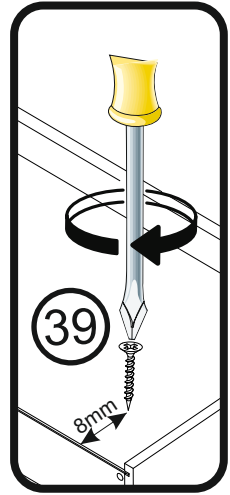
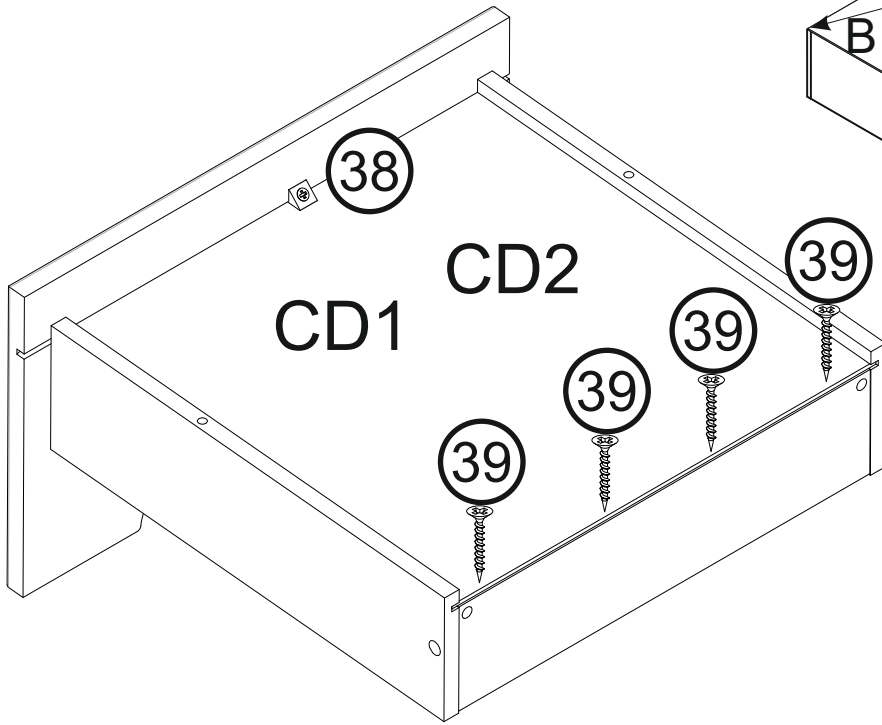
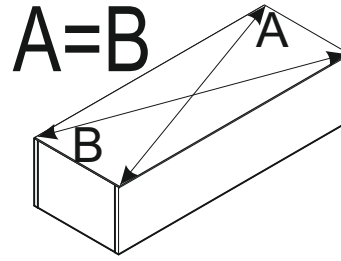
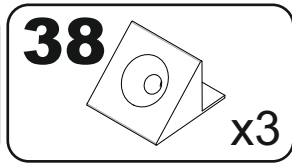
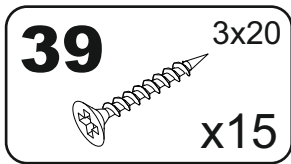

18

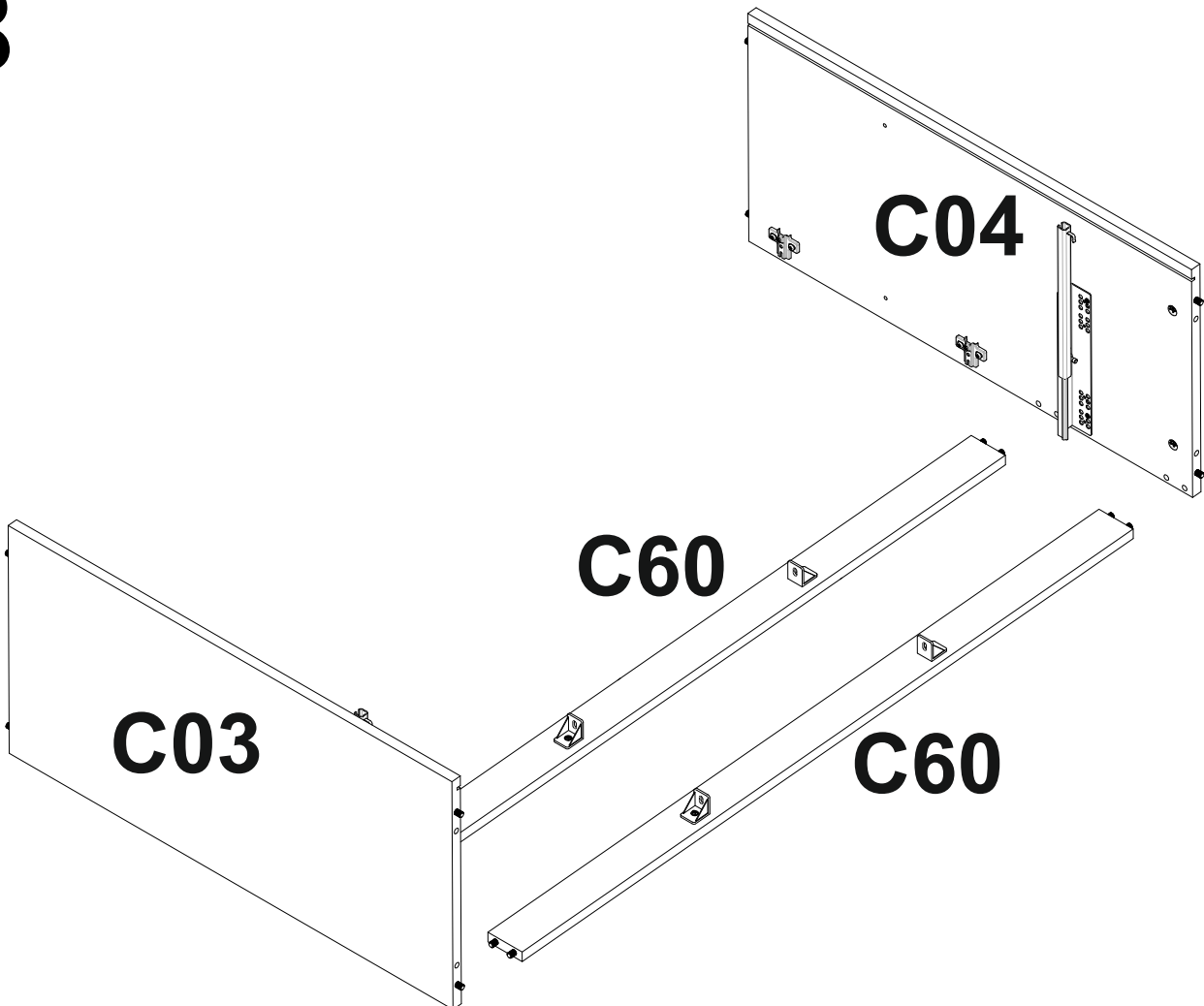

19

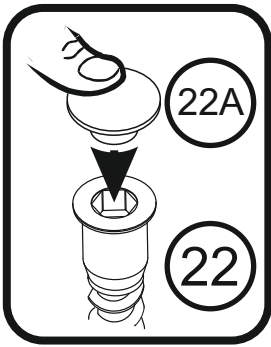
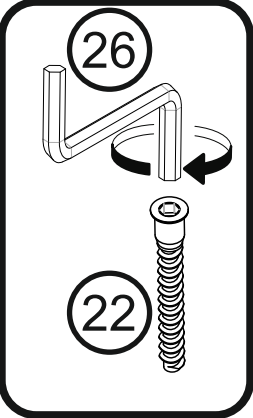
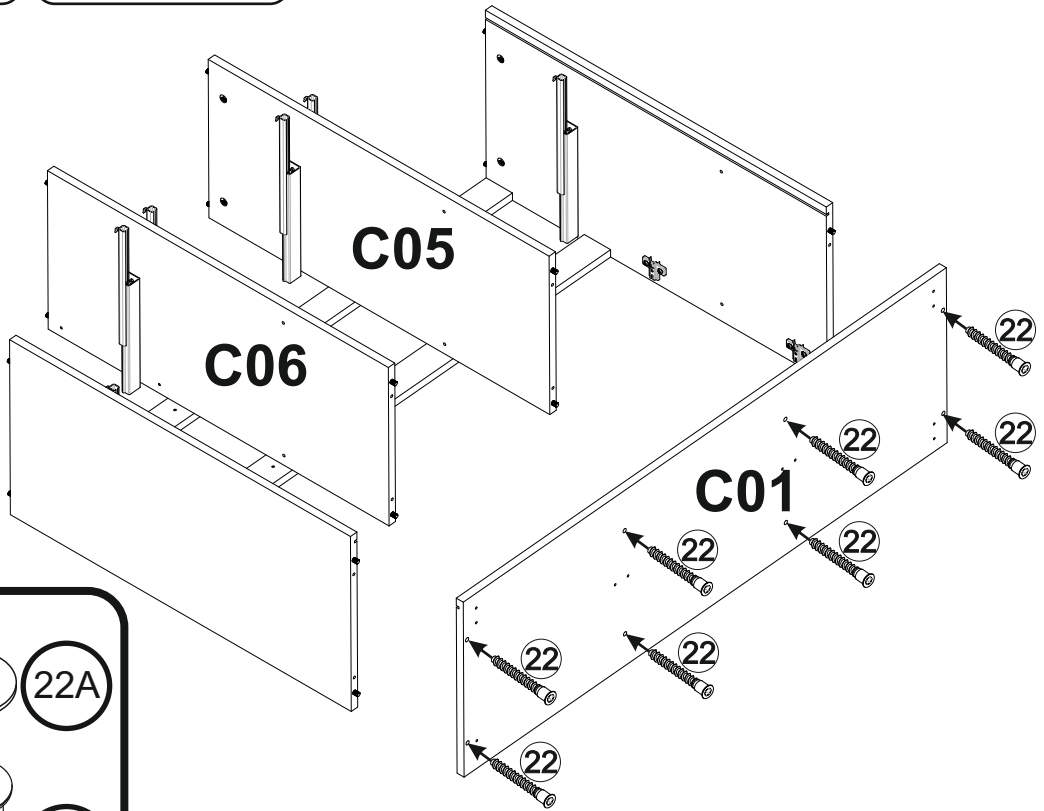
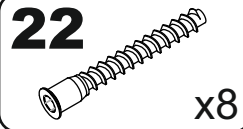

20

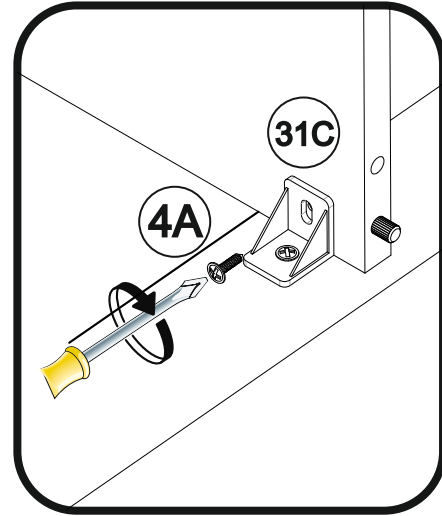
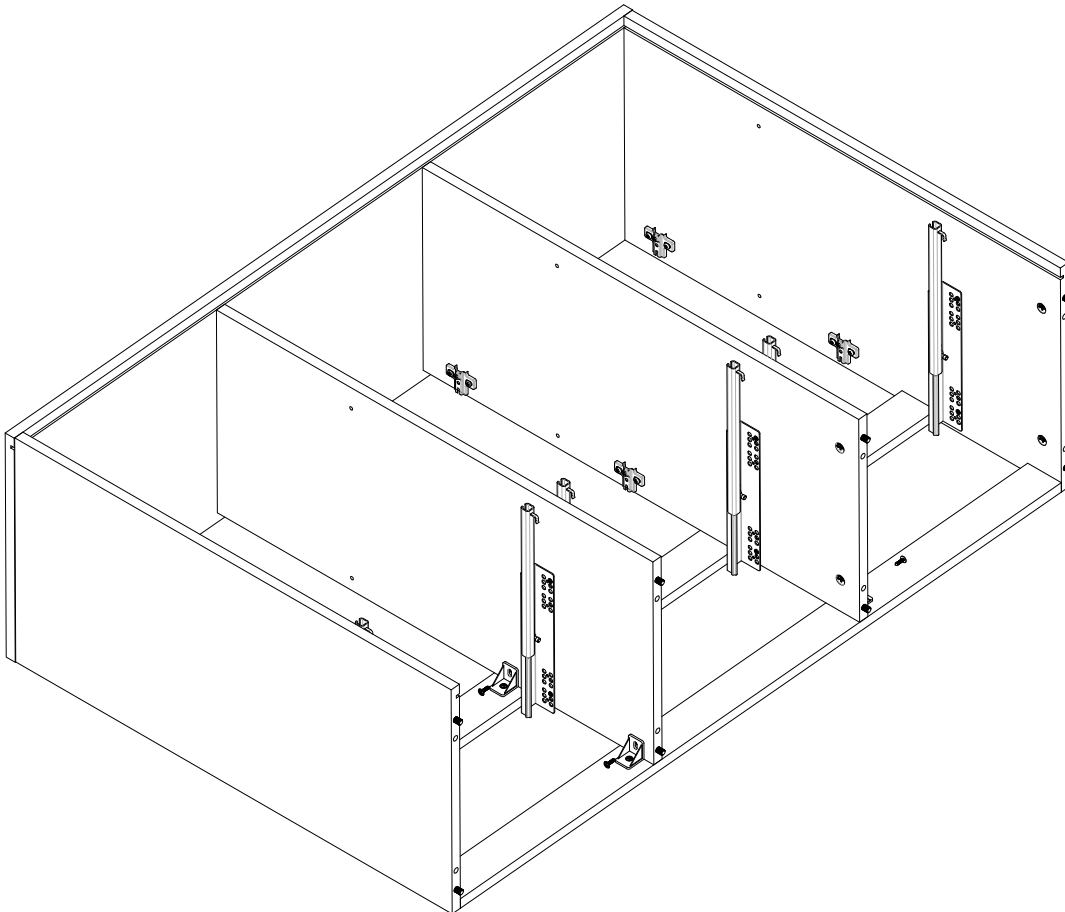
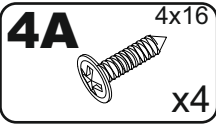

21

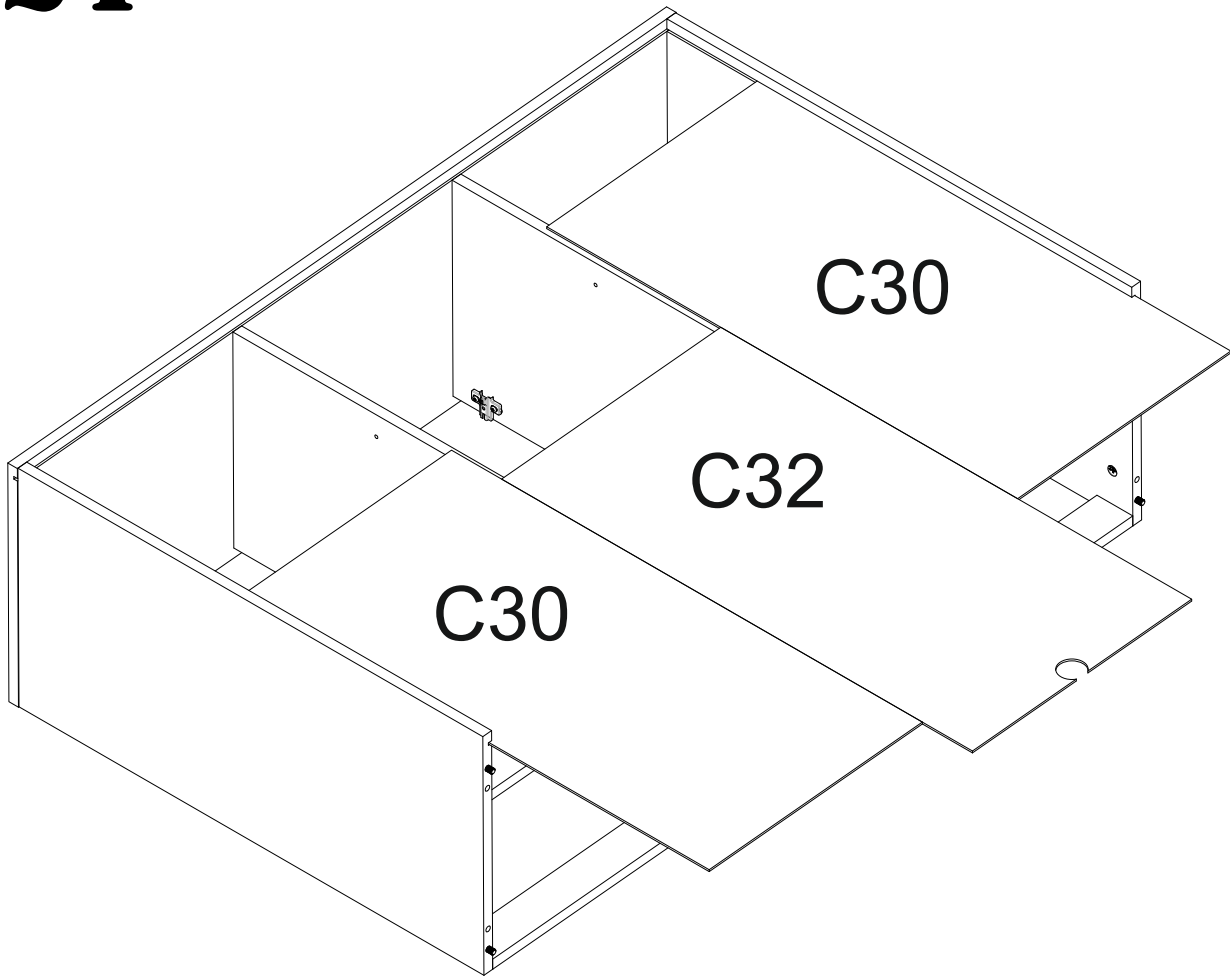

22

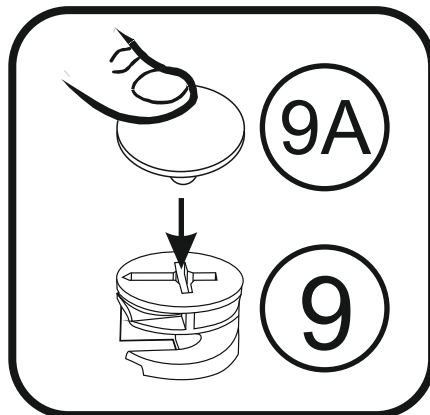
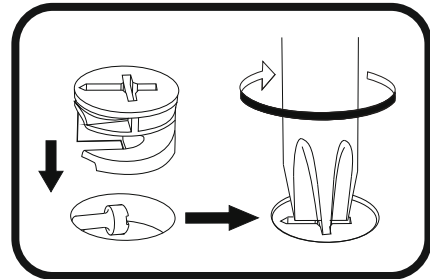
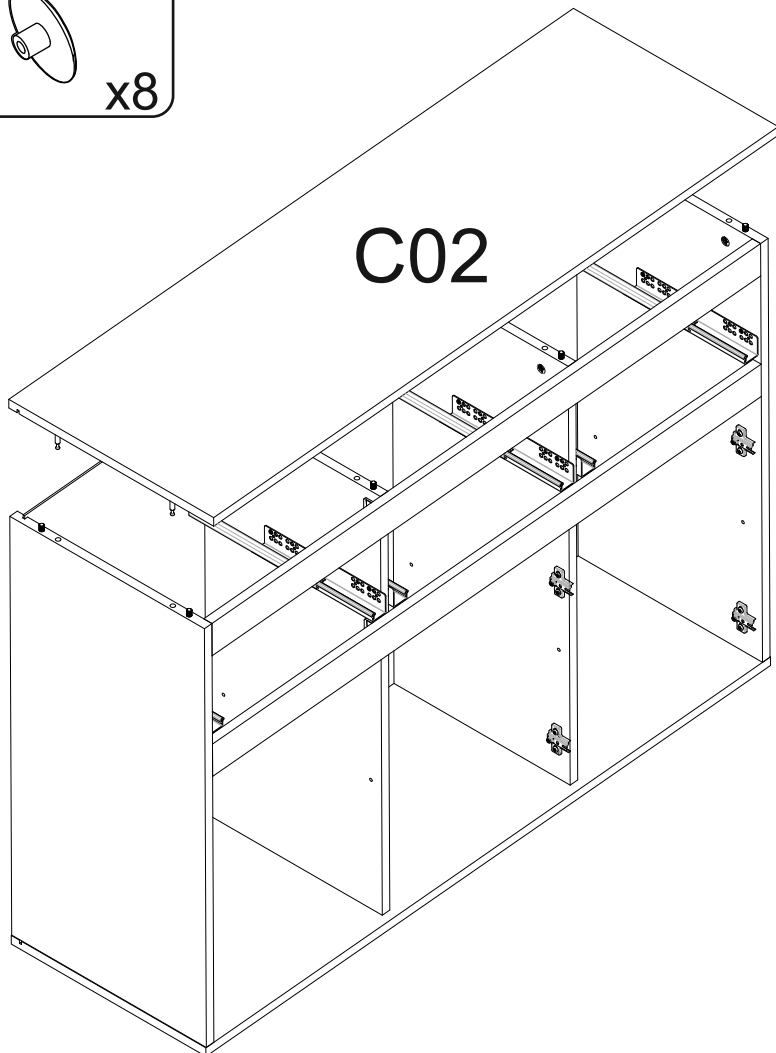
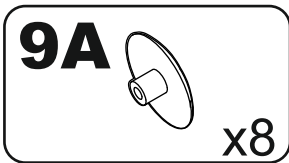

23

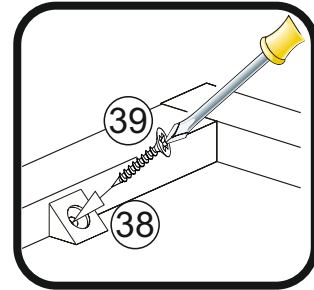
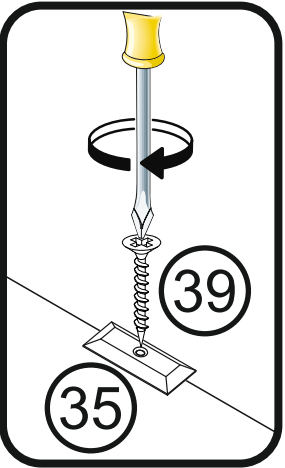
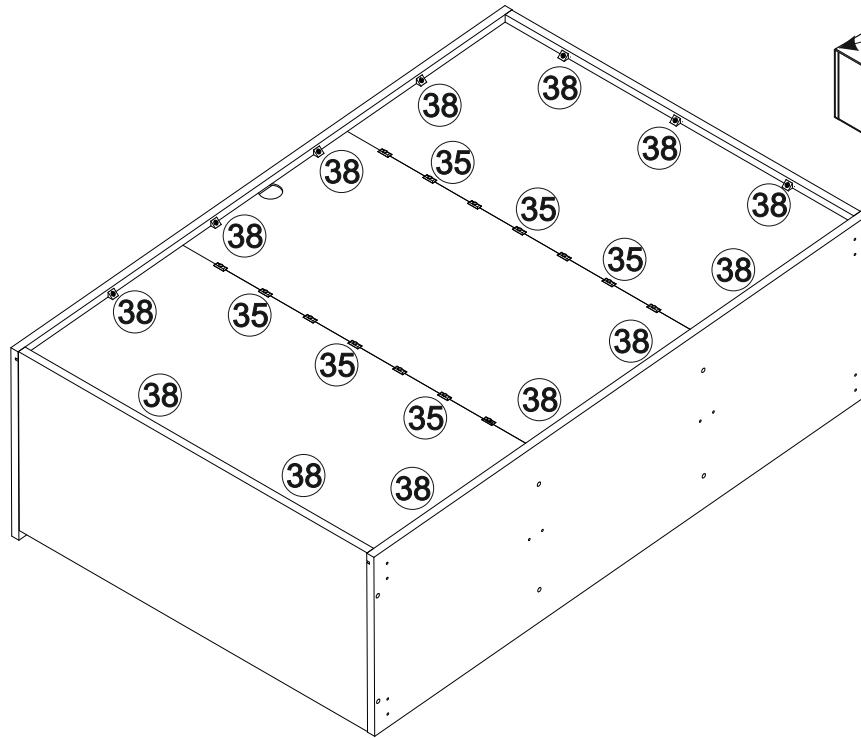
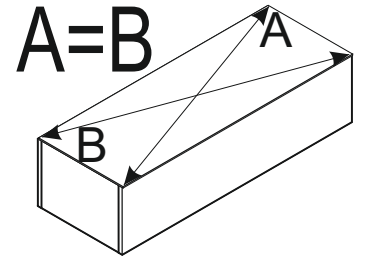
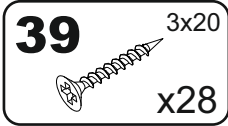
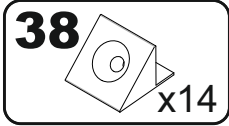
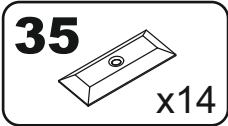

24

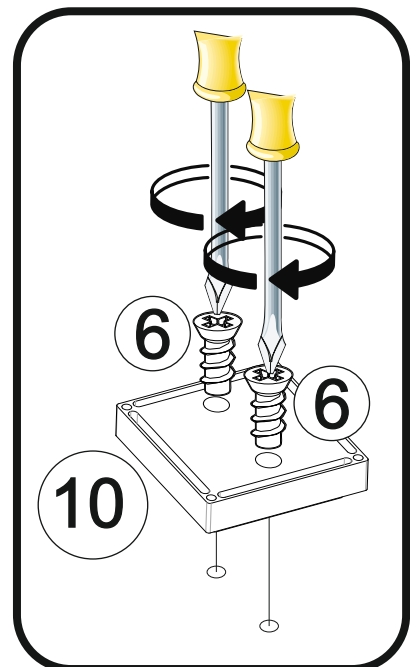
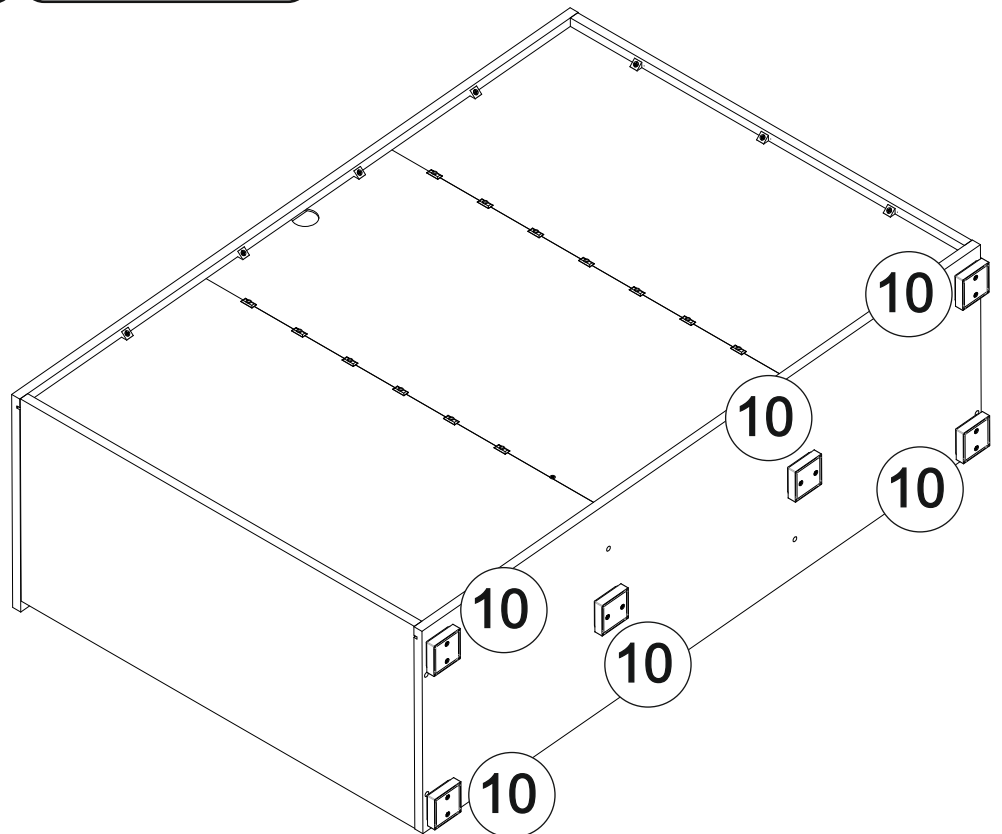
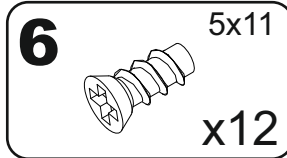
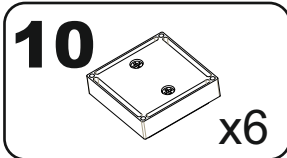

25

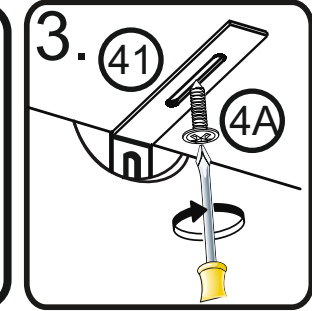
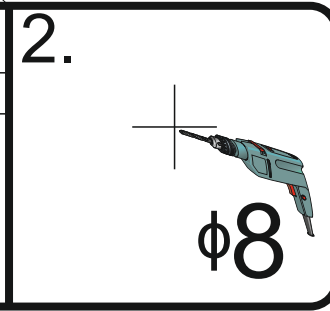
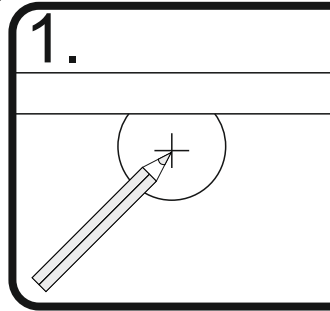
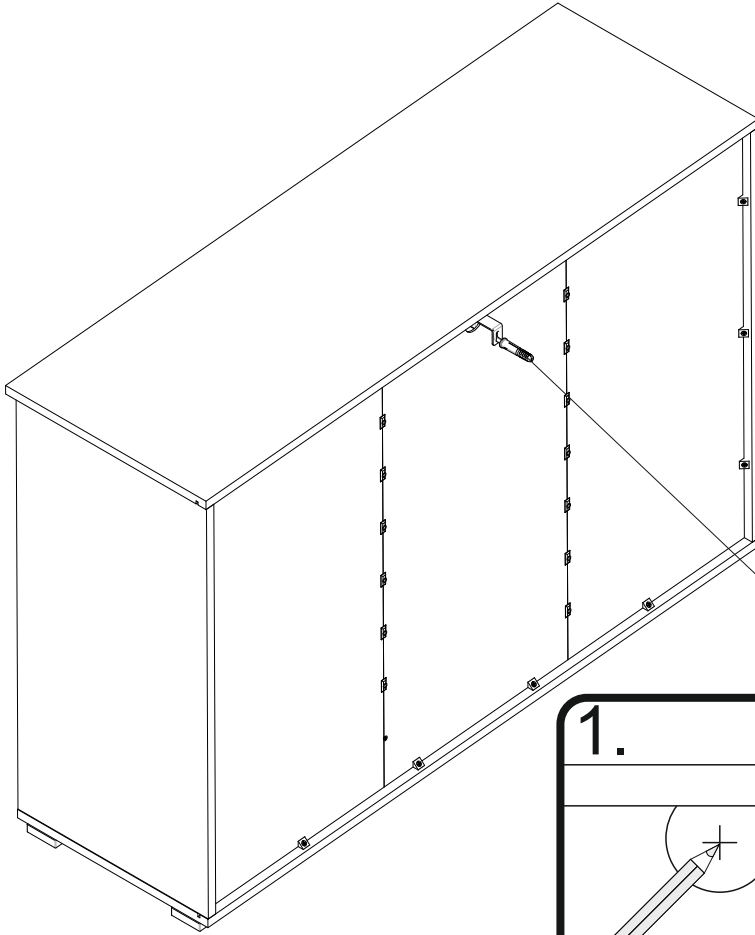
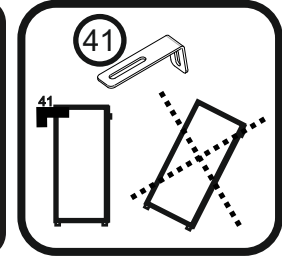
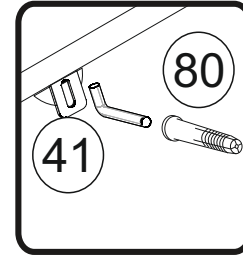
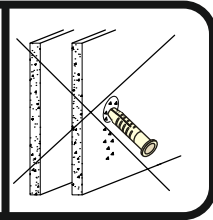
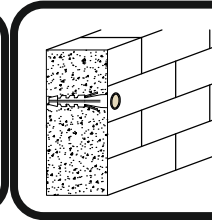
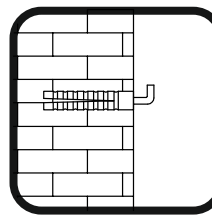
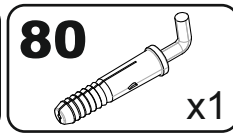
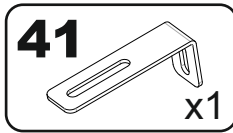
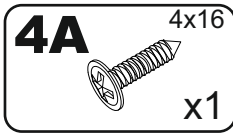

26

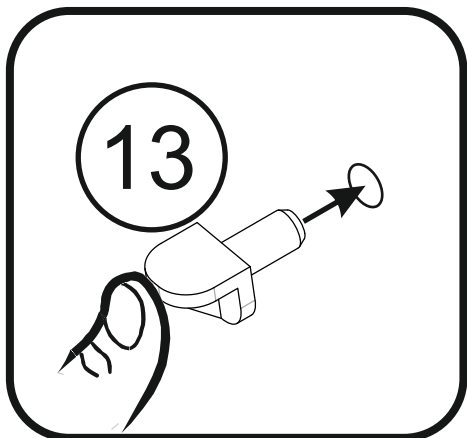
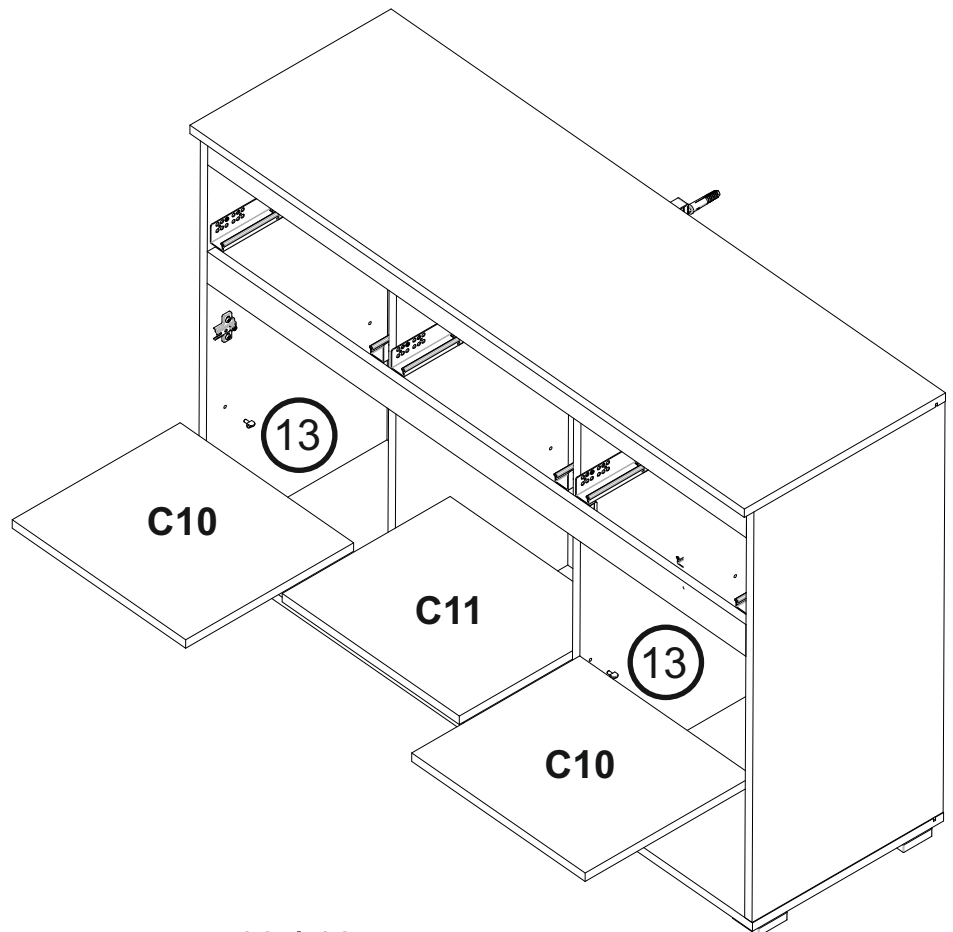
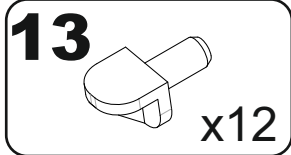

27

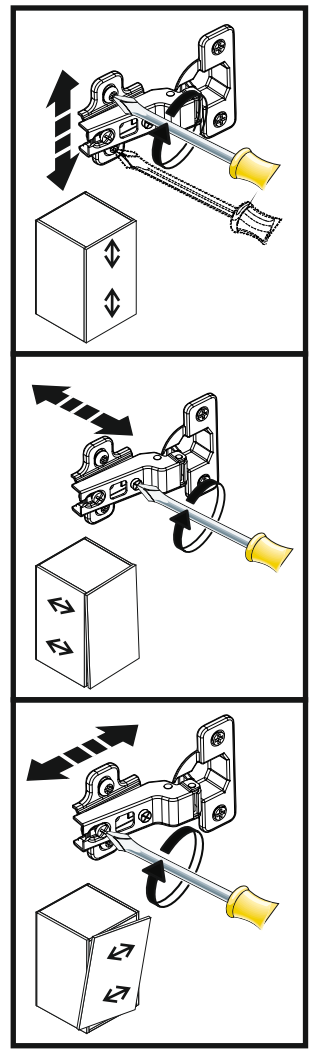
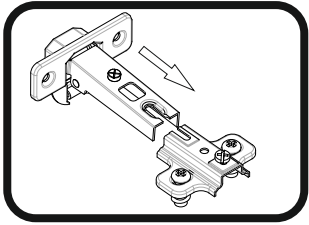
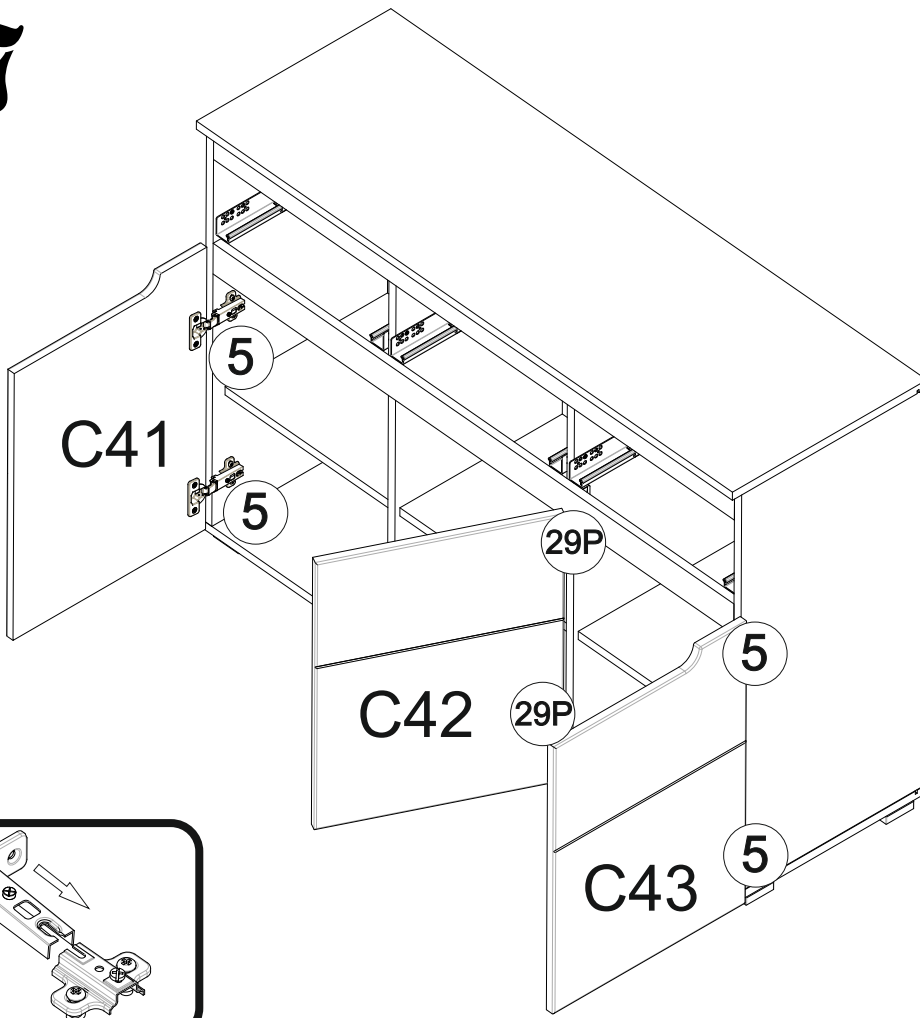

28

